



UAN: 021-111-203-203

Email: sales@interwoodmobel.com

www.interwood.pk | www.corporate.interwood.pk

Twitter /interwoodmobel Instagram /interwoodcorporate

For corporate queries email:

corporate@interwoodmobel.com

SHOWROOMS

Islamabad/ Rawalpindi

- Golra Showroom
Plaza - 39, Furniture Market
Opposite CMT, Golra Road
Rawalpindi / Islamabad 45710

- DHA Islamabad Showroom
Main GT Road, Opposite Gate 4,
DHA Phase 2,
Islamabad, 45710

- I-9 Showroom
Plot # 390, Street No. 16,
Potohar Road
(Near I-9 Police Station),
I-9/3, Islamabad,
Islamabad Capital Territory, 45710

Lahore

- Garden Town Showroom
7, Babar Block
New Garden Town, Lahore,
Punjab, 54600

- DHA-Y Block Showroom
211-Y block, Commercial Area
Sector Y DHA Phase 3,
Lahore, Punjab, 54000

Peshawar

- Hayatabad Showroom
Saif Shopping Mall
Phase 3 Chowk
Jamrud Road, Peshawar

Karachi

- LuckyOne Showroom
Shop No. LG-14, Lower Ground Level,
LuckyOne Mall,
Rashid Minhas Road,
Karachi, Sindh, 74600

- DHA Bukhari Showroom
Building No. 43-C,
Bukhari Lane No. 11, Bukhari Commercial Area,
Phase 6 DHA, Karachi, Sindh, 74600

Gujranwala

- Estate No. 1, Plot No. 1-A
Small Industrial Estate,
Near Suzuki Motors - GT Road,
Gujranwala, Punjab, 52250

CERTIFIED BY:



The mark of
responsible forestry
FSC® C136041

KITCHENS

CATALOGUE

2023

EDITION-1

May, 2023

YASQUEEN 111-927-336



CHAIRMAN'S MESSAGE

Interwood is today a household brand name that is synonymous with high-quality international standard furniture, including home & office furniture, kitchens, doors, wardrobes, flooring, accessories and so much more. In addition to catering to homes, however, we also lend our brand of ready-made and customized furnishing solutions to hospitals, educational institutions, banks, corporations, hotels, luxury residences, retail brands and mega infrastructural projects like international airports. We are humbled by our achievements and are grateful to our partners, our competitors and of course our customers in helping us reach to where we are today. We remain ever-committed to continue evolving and delivering high-quality and affordable products to our customers.

PURPOSE

To inspire everyone for a better lifestyle.

VISION

Becoming the global lifestyle trendsetter, loved by all at home and at the workplace.

OUR VALUES

Love for Customers
Service | Respect | Agility

Re-Imagine
Growth | Innovation | Automation

Transparency
Honesty | Openness | Accountability

Collaboration
Connection | Empowerment



Our Manufacturing Facility, Lahore

Interwood's state-of-the-art manufacturing facility spans 600,000 sqft. and is equipped with over 300 of Europe's modern machines including fully-automated technology that is capable of processing a variety of different components for various products ensuring maximum efficiency and flexibility in production.



At Interwood Mobel Pvt. Ltd. quality is an integral part of our core business values. We are committed to delivering the top-most quality products, conforming to the highest international standards.

Our effective and efficient Quality Management System is based on the requirements of ISO 9001:2015. Our commitment to excellence is based on continual improvement in design, technology, materials and human resource development.



Ever since its inception in 1974, Interwood has directed its efforts in developing better interiors for homes and corporate establishments. It is our constant endeavor to raise standards in design, quality, durability, and innovation – the only aspect we ever lower, is the price. Our designers think differently, they understand the varied moods, colours, and temperaments. All our products are designed with only one thing in mind – You!



INDEX



Minimal 01



Soho 07



Vogue 15



Brooklyn 21



Dialogue & Arctic 29



Hazel 37



Opera 51



Claire 27



Free 29



Country 33



Arroyo 35



Iris 41



Imperial 49



Dusk 53



Moreno 55



Dune 59



Kitchen Accessories 61



Kitchen Appliances 65



Worktops 76



Handles 77



LED Lights 78



Cabinetry 79



MINIMAL

THE BEAUTY OF SIMPLICITY



If you love originality and measured elegance, then minimal is the kitchen for you, designed to make your time in the kitchen a real pleasure.



PALETTE



KENDAL OAK
18 mm



ONYX GREY
18 mm

BASE UNITS
carcass: mangolia
fronts: kendal oak
handle: profile
worktop: carbon aggregate

TALL UNITS
carcass: formite
fronts: onyx grey
base: onyx grey
handle: horizontal profile,
dummy front: door at floor level



AVAILABLE IN

LAMINATES

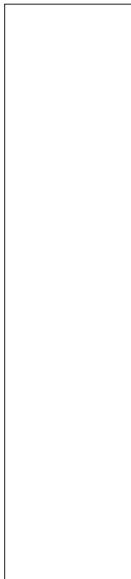

WHITE
(LIMITED) 18 mm



ONYX GREY
18 mm



ALANDPINE
18 mm



KENDAL OAK
18 mm



KANSAS OAK
18 mm



TOBACCO OAK
18 mm



BAJRI GLASS IN PROFILE
4/20 mm

GLASS



SOHO

A METROPOLITAN KITCHEN





Designed in the spirit of the Loft Style and inspired by an urban mood. Soho is a fusion of different materials that gives the kitchen its metropolitan core and appeal.



PALETTE



ALANDPINE
18 mm

WHITE
18 mm

INDUSTRIAL GLASS
IN PROFILE
4/18 mm

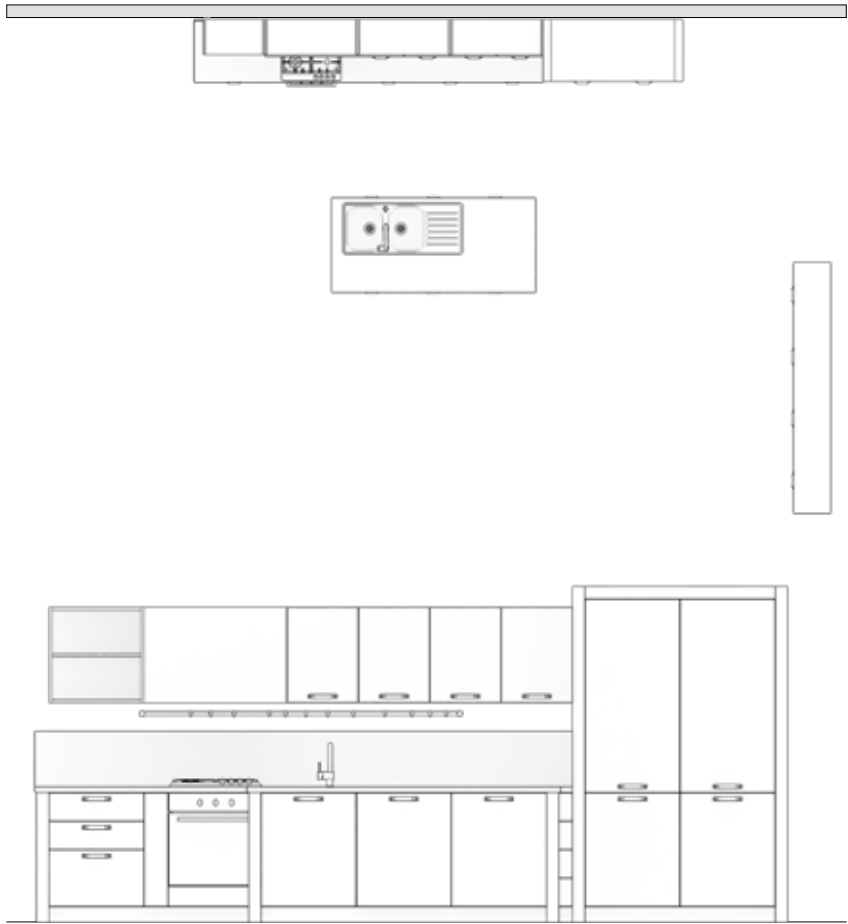

- **BASE & TALL UNITS**
carcass: white
fronts: alandpine
handle: fg010015315
worktop: carbon aggregate
- **WALL UNITS**
carcass: white
fronts: white and industrial glass in mfc
base: open shelves in white and alandpine

AVAILABLE IN

LAMINATES

WHITE
(LIMITED) 18 mm

ONYX GREY
18 mm

ALANDPINE
18 mm

KENDAL OAK
18 mm

KANSAS OAK
18 mm

TOBACCO OAK
18 mm

GLASS

INDUSTRIAL GLASS
IN PROFILE
4/18 mm



VOGUE

AN OUTSTANDING BALANCE OF FINISHES

A kitchen with well-defined proportions, minimalist contours, and sophisticated range of finishes. Everything one needs in a perfect kitchen.



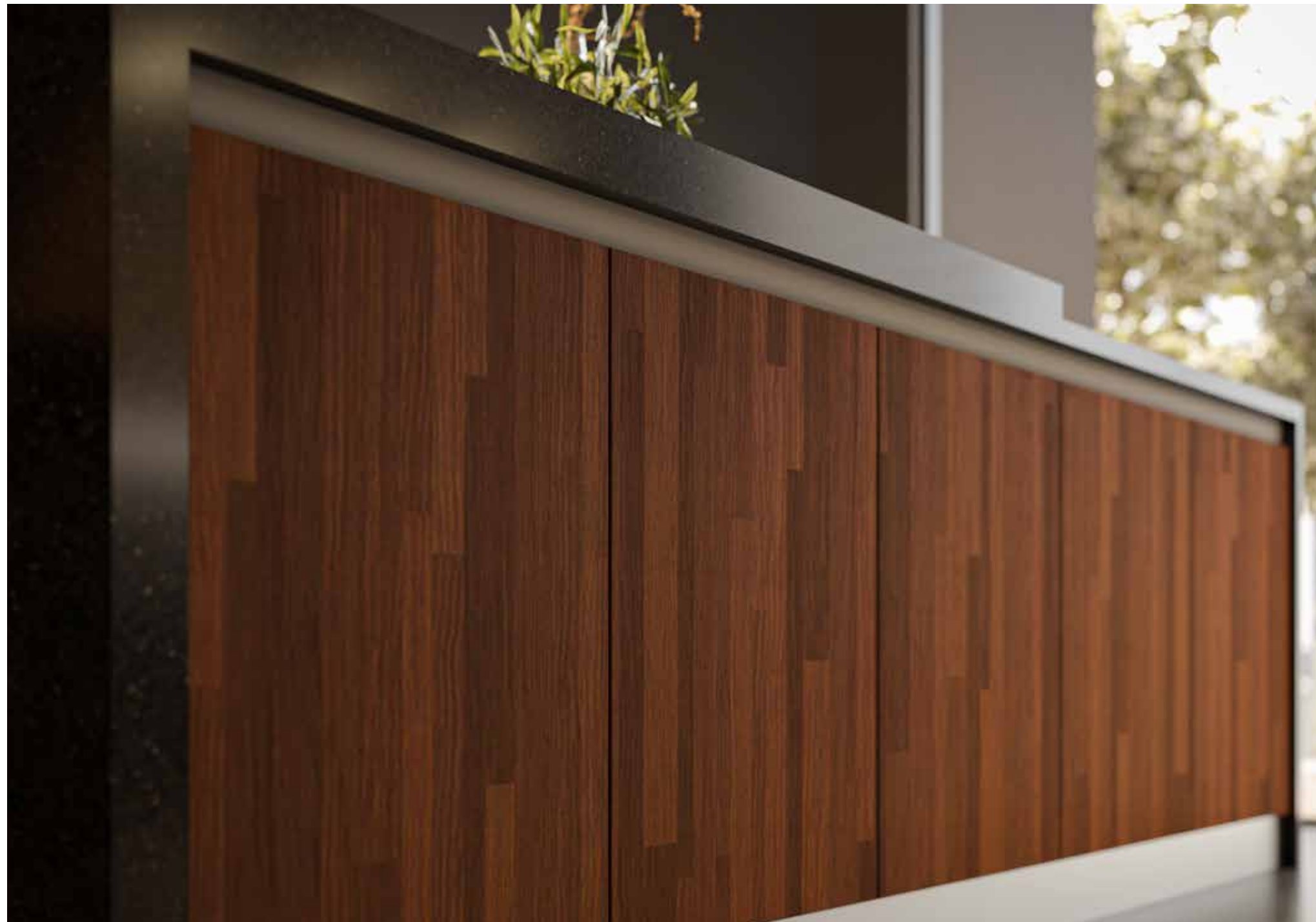

PALETTE



NATURAL WALNUT
18 mm



ONYX GREY
18 mm

— **BASE, WALL & TALL UNITS**
carcass: natural walnut & formite
fronts: onyx grey
worktop: carbon aggregate
handle:
FG010014813, FG010014788
FG010026724, FG010026725

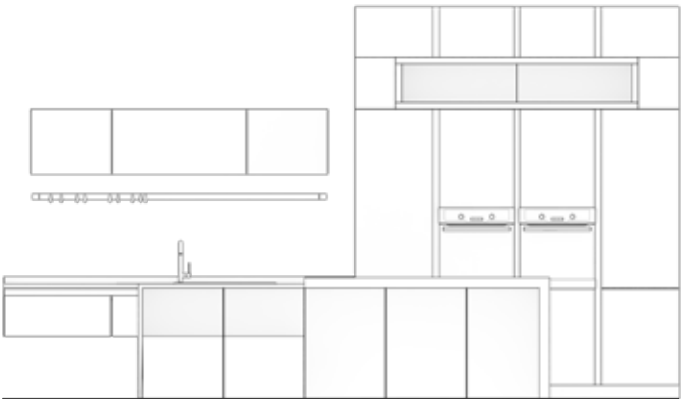

AVAILABLE IN

MATT PAINT



WHITE
18 mm

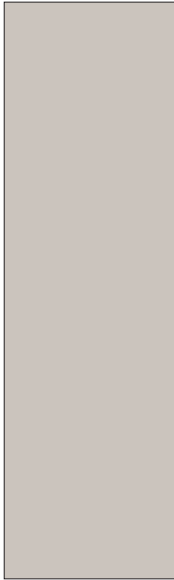

WARM GREY 2C
18 mm

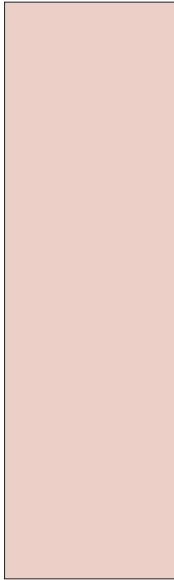

WARM GREY 6C
18 mm

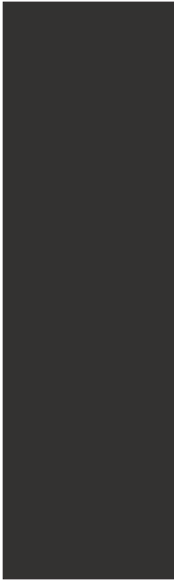

ONYX GREY
18 mm

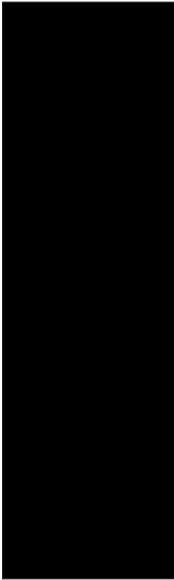

BLACK
18 mm

LAMINATE



KERALA CONCRETE
17 mm

VENEER



NATURAL WALNUT
18 mm

GLASS



BAJRI GLASS IN PROFILE
4/20 mm



BROOKLYN

INDUSTRIAL DESIGN FINDS A NEW BALANCE





The Brooklyn kitchen is a link between the classic allure of yesterday and the innovative look of today. This elegant kitchen features a distinctive industrial style enhanced by attention to detail.



PALETTE

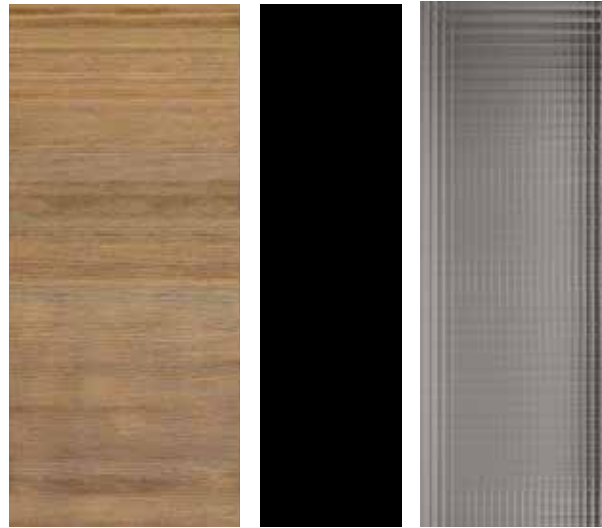

BRUSHED OAK NATURAL
25 mm

BLACK
25 mm

INDUSTRIAL GLASS
4/25 mm

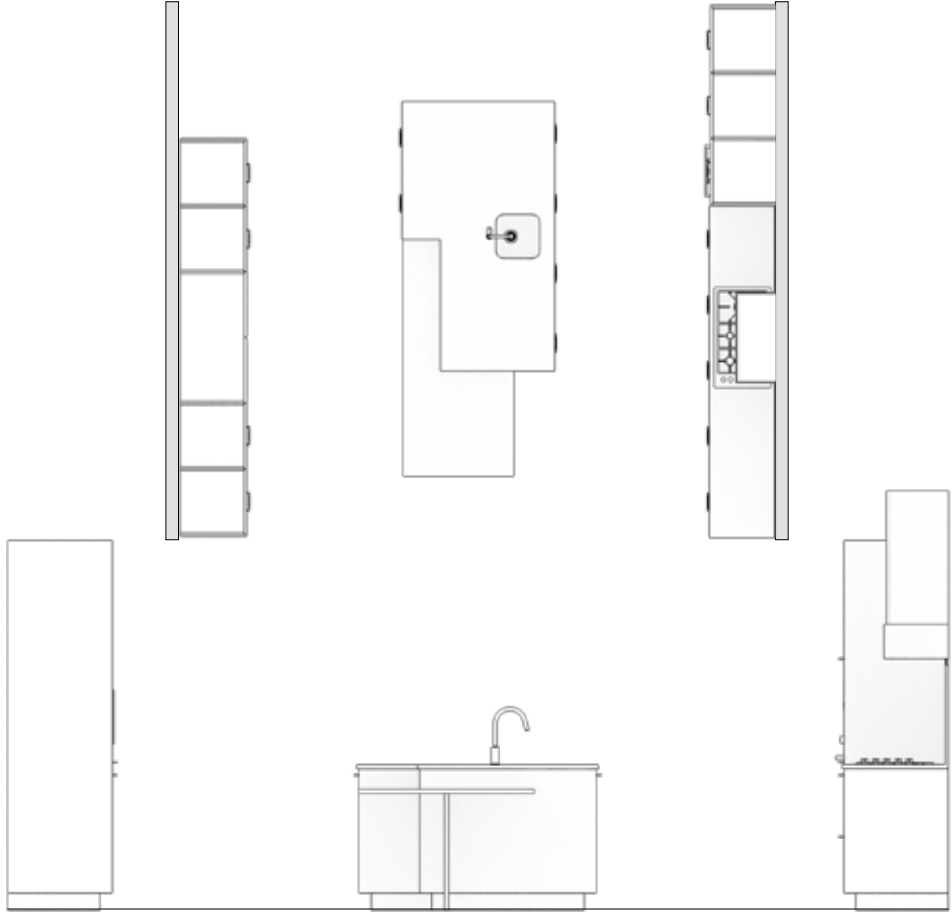

BASE UNITS
carcass: formite
fronts: brushed oak natural
worktop: carbon aggregate
handle: FG010015316

TALL UNITS
carcass: formite
fronts: black paint
glass: industrial

AVAILABLE IN

MATT PAINTS

WOOD CLADDING

GLASS

WHITE
25 mm

WARM GREY 2C
25 mm

WARM GREY 6C
25 mm

ONYX GREY
25 mm

BLACK
25 mm

BRUSHED OAK NATURAL
25 mm

BRUSHED OAK SMOKE
25 mm

INDUSTRIAL GLASS
4/25 mm



DIALOGUE & ARCTIC

ESSENTIAL LINES AND A CONTEMPORARY SOUL





From sleek cabinetry to sophisticated color schemes, this contemporary kitchen blends modern design with minimal aesthetics to create a distinctive look that transcends trends.

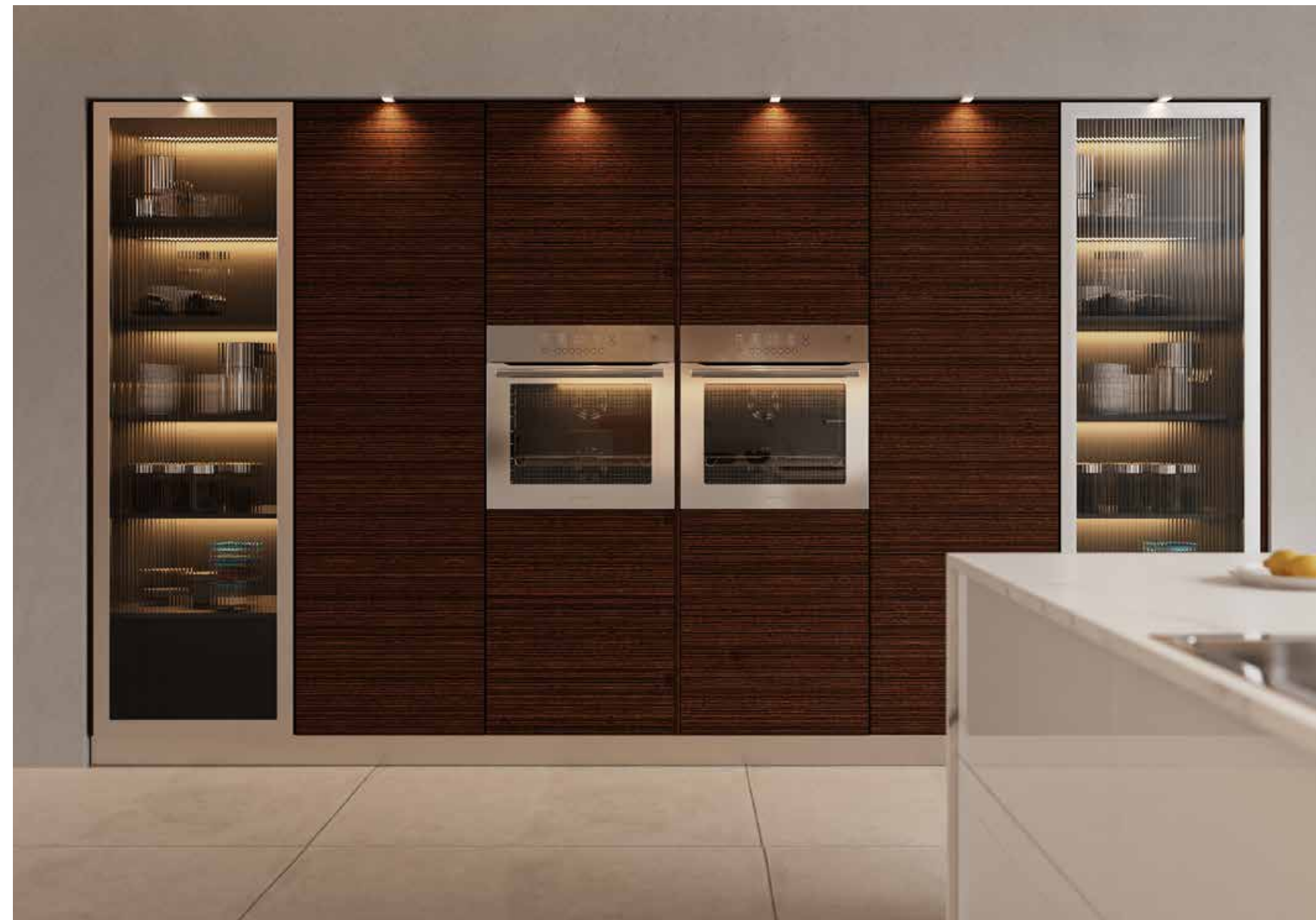

PALETTE



WENGE
18 mm

WHITE
18 mm

FLUTED GLASS
4/21 mm

BASE & WALL UNITS
carcass: mangolia
fronts: white painted
glass: fluted
worktop: aura
handle: FG010015298

TALL UNITS
carcass: formite
fronts: wenge veneer
glass: industrial

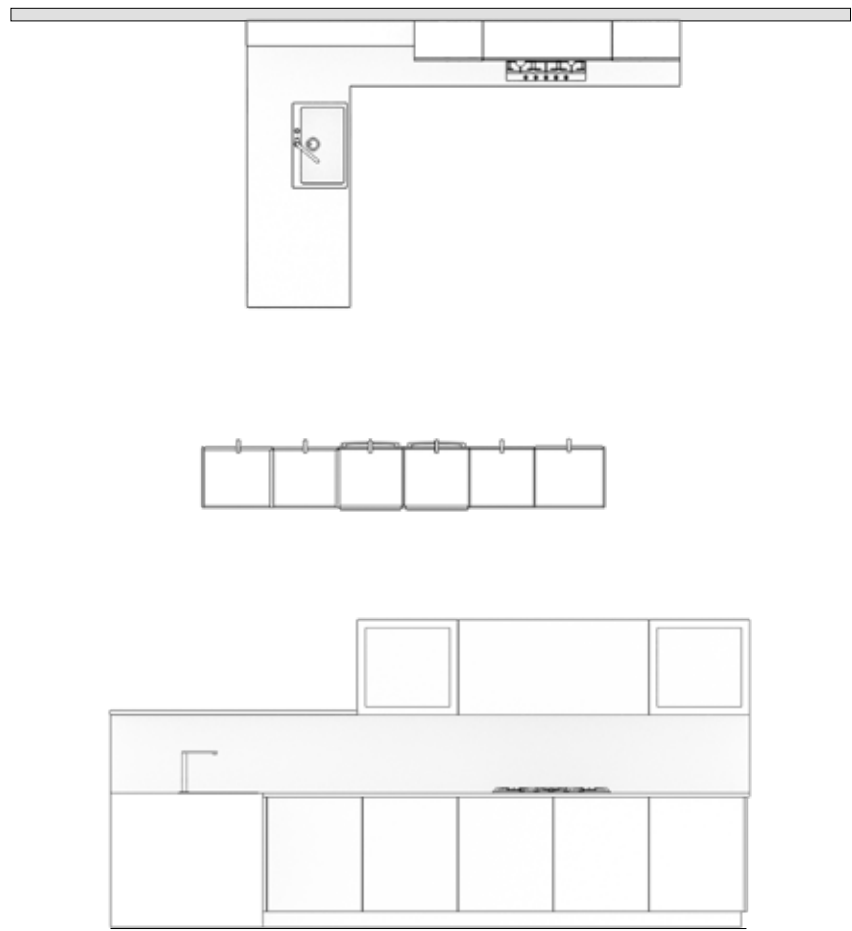

AVAILABLE IN





HAZEL

AN OUTSTANDING BALANCE OF FINISHES

A kitchen that extends intelligently, surprising you not only with its eye-catching design but also with the sophistication and quality of its materials.



PALETTE

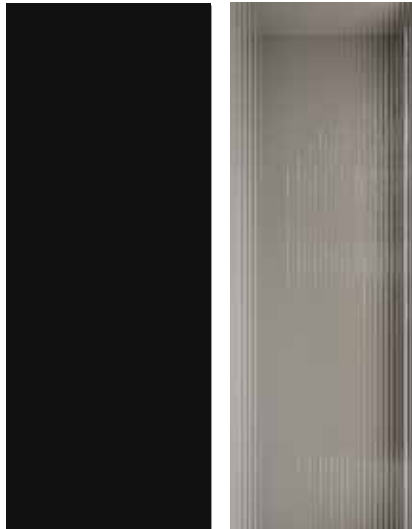

BLACK
18 mm

FLUTED GLASS
18 mm

— **BASE, WALL & TALL UNITS**
carcass: formite
fronts: black painted
glass: fluted
worktop: kelya
handle: FG010015298



AVAILABLE IN

HIGH GLOSS PAINTS

GLASS

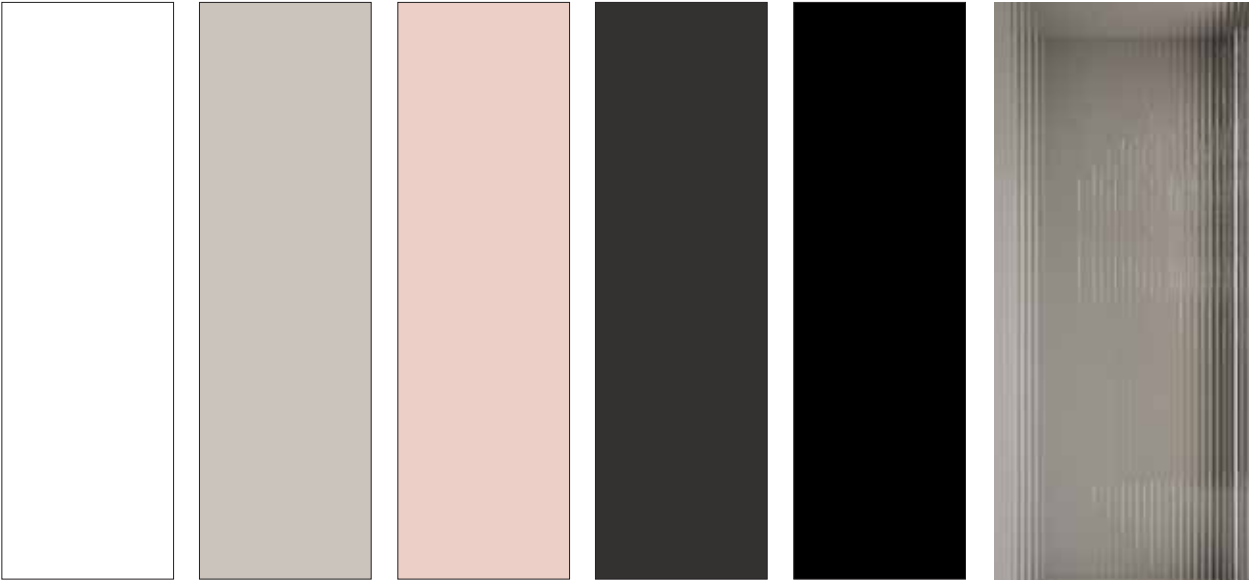

WHITE
18 mm

WARM GREY 2C
18 mm

WARM GREY 6C
18 mm

ONYX GREY
18 mm

BLACK
18 mm

FLUTED GLASS
4/21 mm



CLAIRE

NEW CLASSIC FOR A CONTEMPORARY HOME





Claire presents a sophisticated appeal and love for tradition in a kitchen that blends the fascination of the past with an elegant contemporary soul of today.



PALETTE



JACOBEAN
22 mm



ANTIQUE WHITE
5/22 mm



GOLDEN ANTIQUE MIRROR
5/22 mm

— **BASE, WALL & TALL UNITS**
carcass: mangolia
fronts: jacobean & antique white
handle: FG040001065

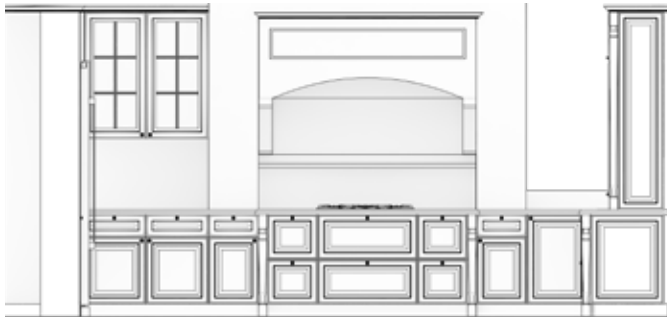
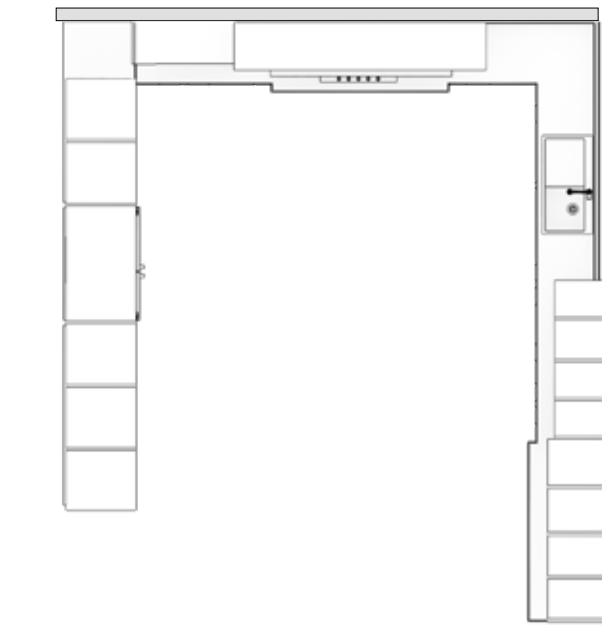

AVAILABLE IN

— VENEER/POLISH —



ANTIQUE WHITE
22 mm



JACOBEAN
22 mm

— GLASS —



GOLDEN ANTIQUE MIRROR
5/22 mm



OPERA

THE ABSOLUTE CLASSIC



The elegant style of this classic kitchen gives your home an authentic feel, teamed with delightful decorative motives and exclusive style.



PALETTE



OPERA WALNUT
18 mm



OPERA WHITE
18 mm



SOFT DOT GLASS
4/22 mm

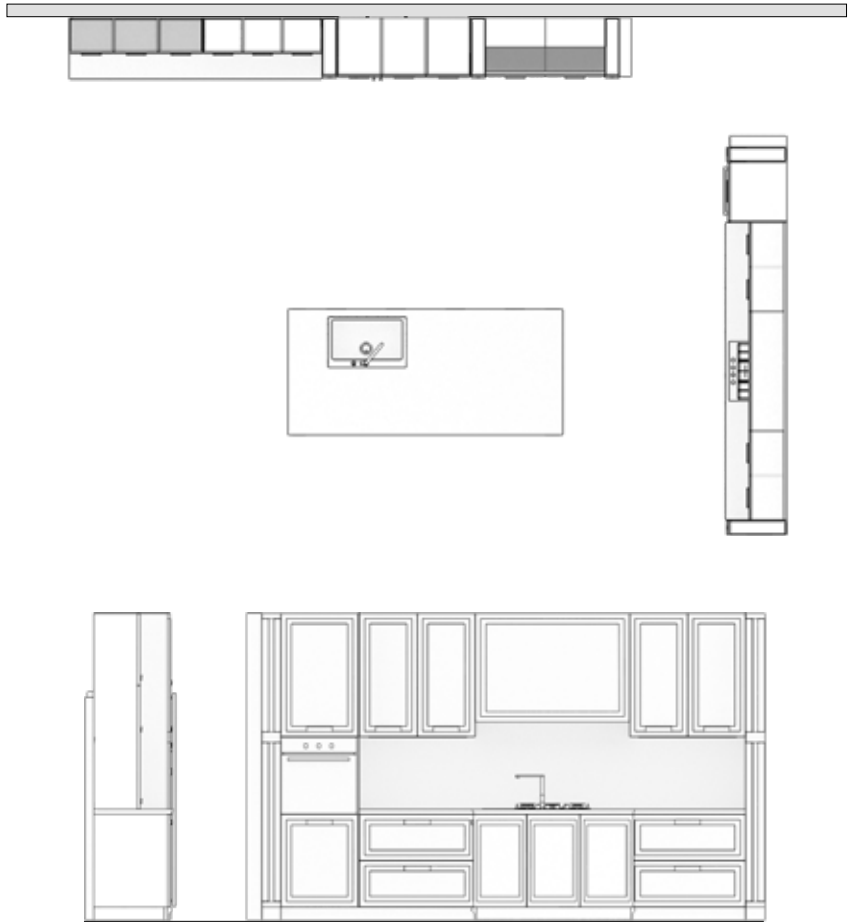

— **BASE, WALL & TALL UNITS**
carcass: mangolia
fronts: opera walnut & white finish
worktop: aura
handle: FG040001060

AVAILABLE IN

POLISH

GLASS

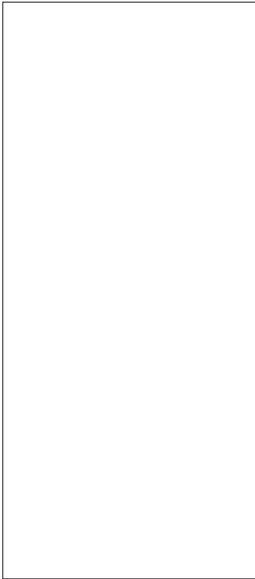

OPERA WHITE
18 mm



OPERA WALNUT
18 mm



SOFT DOT GLASS
4/22 mm



FREE

A MODEST STYLE, A BEAUTIFUL SENSATION



A Kitchen with simple, clean lines in which even the smallest details are designed to deliver everything you need from a kitchen and more.

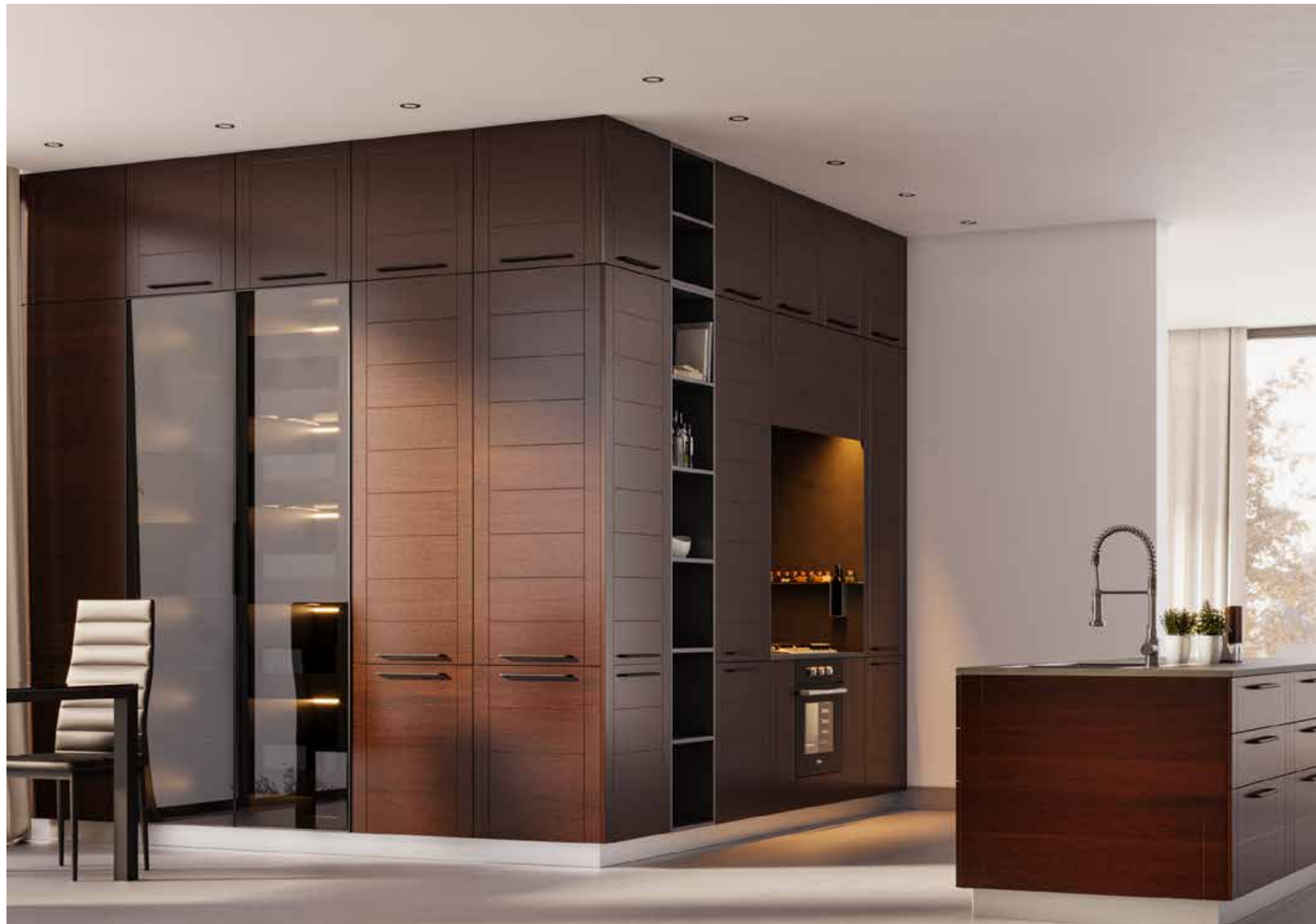

PALETTE



WALNUT
18 mm

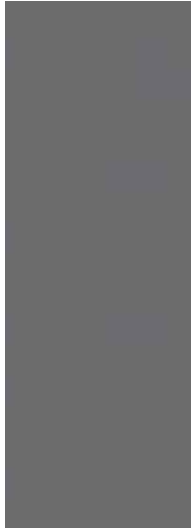

GREY MERCURY
5/22 mm

— **BASE, WALL & TALL UNITS**
carcass: formite
fronts: walnut
worktop: kelya

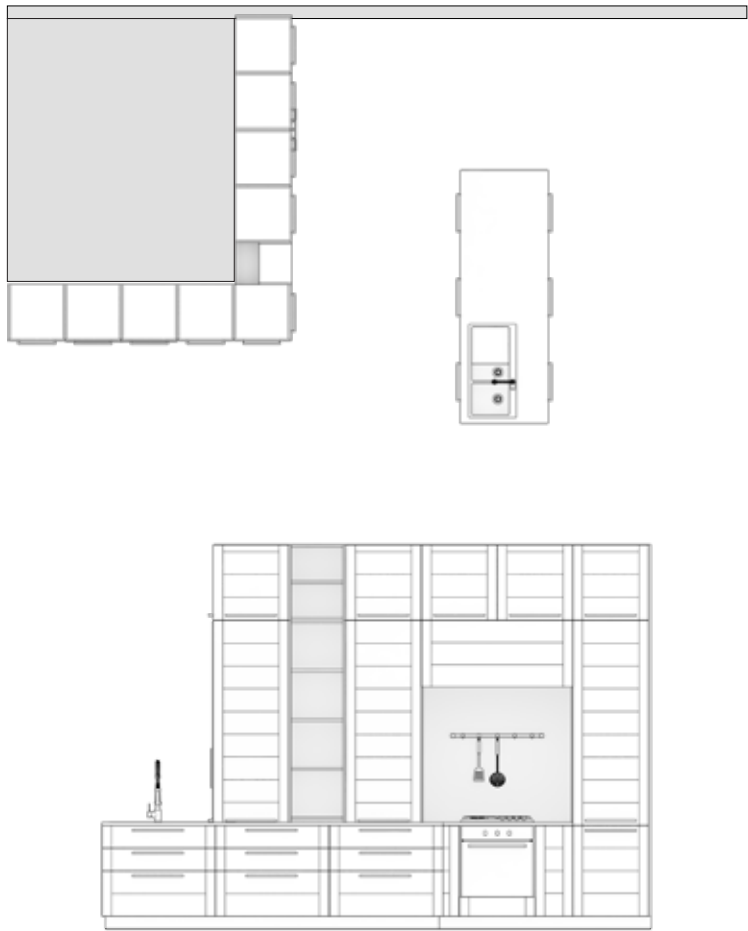

AVAILABLE IN

VENEER/WOOD		GLASS
		
TEAK 18 mm	WALNUT 18 mm	GREY MERCURY 5/22 mm



COUNTRY

FOR THE LOVE OF COUNTRY LIFE





Inspired by the culture of old country life, this kitchen features the values and content of a friendlier world to which many of us would gladly return to.



PALETTE

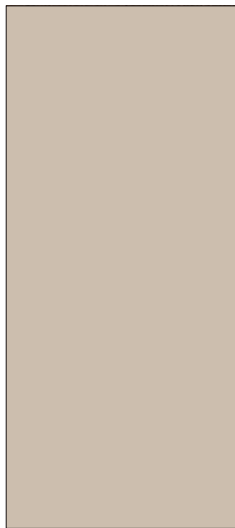

WARM GREY 6C
22 mm



SOFT DOT GLASS
4/22 mm

— BASE WALL & TALL UNITS
carcass: mangolia
fronts: warm grey 6c paint
handle: FG040001259

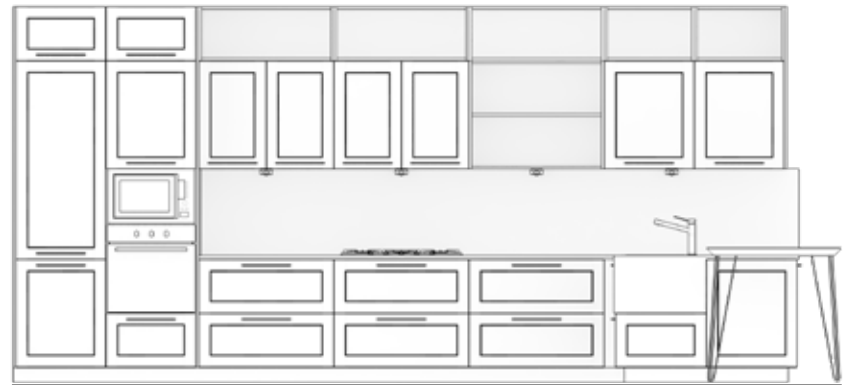
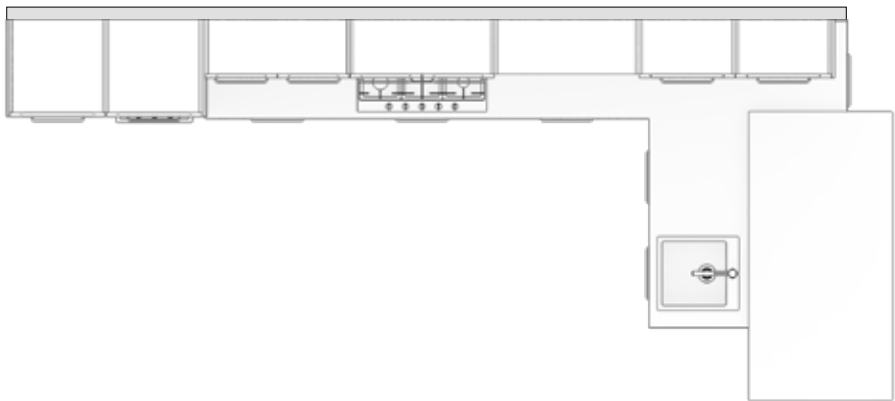

AVAILABLE IN

MATT PAINTS

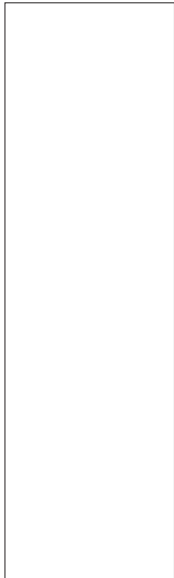

WHITE
22 mm

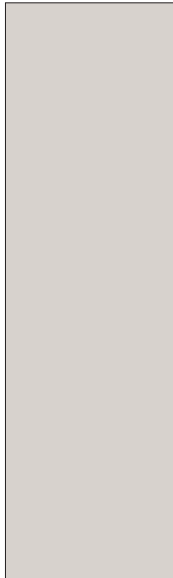

WARM GREY 2C
22 mm

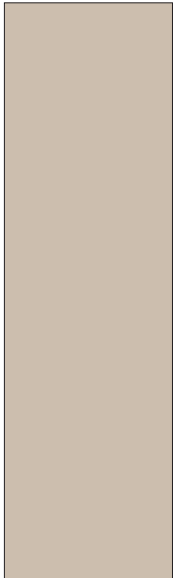

WARM GREY 6C
22 mm

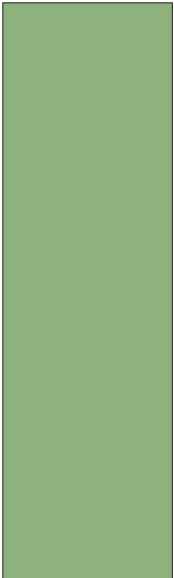

SAGE GREEN
22 mm

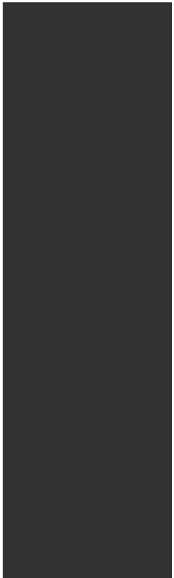

ONYX GREY
22 mm

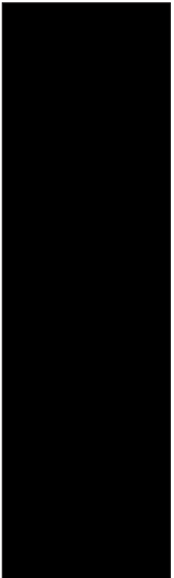

BLACK
22 mm



WALNUT
22 mm

GLASS



SOFT DOT GLASS
4/22 mm



ARROYO

TRANQUIL AND NATURAL DESIGN



The Arroyo Kitchen uses clean flowing lines, a fluted cabinet design and plush marble back splash to mimic the tranquility and beauty of nature.



PALETTE



YELLOW CHESTNUT
25 mm



GRAPHITE
25 mm



BROWN TINTED GLASS
4/25 mm

— **BASE, WALL & TALL UNITS**
carcass: formite
fronts: yellow chestnut and graphite
worktop: kelya
glass: brown tinted

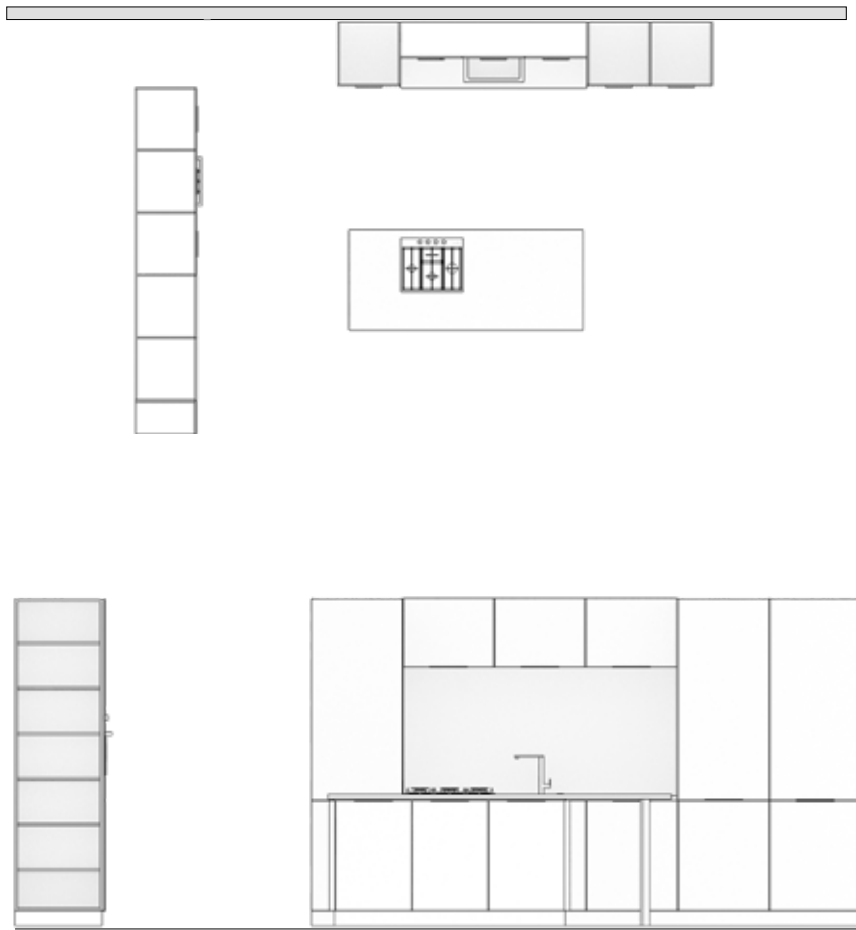

AVAILABLE IN

THERMOSET

GLASS

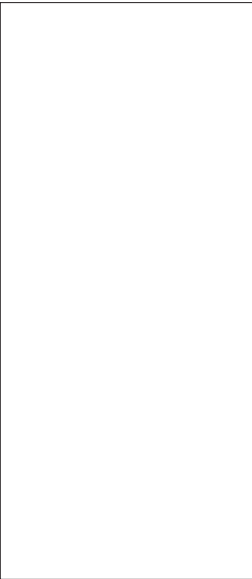

WHITE
25 mm

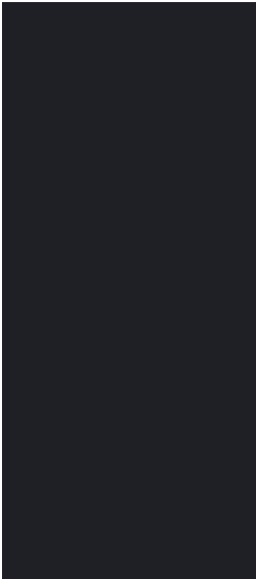

GRAPHITE
25 mm



YELLOW CHESTNUT
25 mm



BROWN TINTED GLASS
4/25 mm



IRIS

STRIKING MATERIALS AND BRIGHT COLORS





This combination of incredibly versatile colors and the material add a pop of vibrancy and character in the kitchen and creates a beautiful sensation.



PALETTE

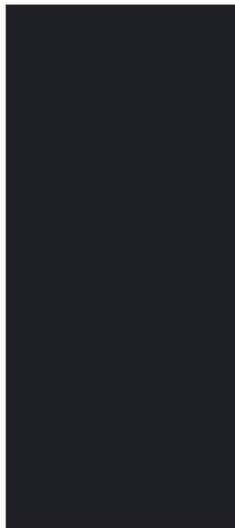

GRAPHITE
25 mm



SOFT DOT GLASS
4/25 mm



— **BASE WALL & TALL UNITS**
carcass: formite
fronts: graphite
worktop: royal brown
glass: soft dot

AVAILABLE IN

THERMOSET

GLASS

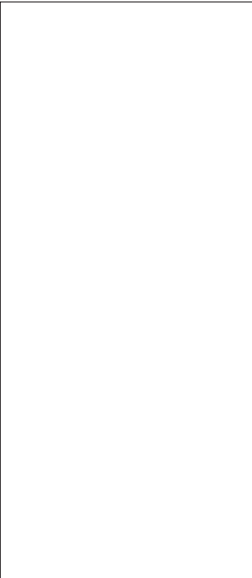

WHITE
25 mm

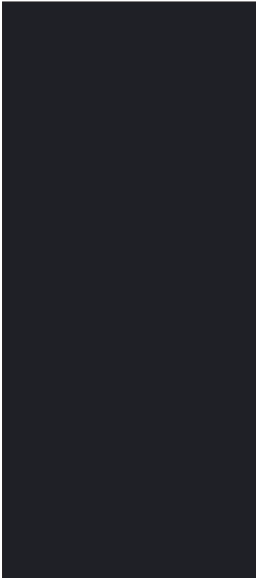

GRAPHITE
25 mm



YELLOW CHESTNUT
25 mm



SOFT DOT GLASS
4/25 mm



IMPERIAL

THE WARMTH OF A TIMELESS DESIGN





There are designs that can never be forgotten. With Imperial kitchen, we want to remember the classics, because we love to innovate but without forgetting the designs which last a life time.



PALETTE

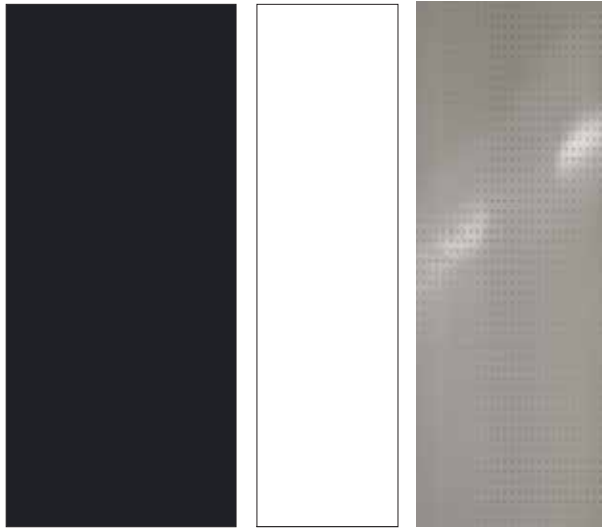

GRAPHITE
25 mm

WHITE
25 mm

SOFT DOT GLASS
4/25 mm

— **BASE WALL & TALL UNITS**
carcass: mangalia
fronts: white and graphite
glass: soft dot
handle: FG040001065

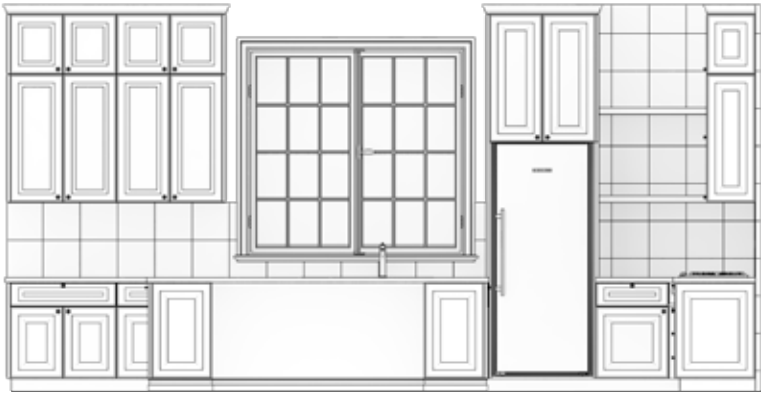
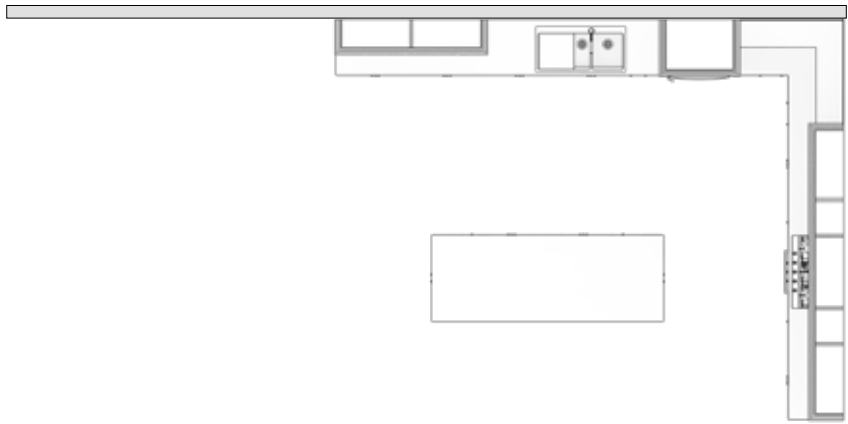

AVAILABLE IN

THERMOSET

GLASS



WHITE
25 mm

GRAPHITE
25 mm

YELLOW CHESTNUT
25 mm

SOFT DOT GLASS
4/25 mm



DUSK

INSPIRED BY AN URBAN MOOD

Dusk is a kitchen of tangible quality in terms of material and design solutions with an aesthetic that is defined with a balanced mix of the "rational" and the "natural".





PALETTE



KENDAL OAK
18 mm

WHITE
18 mm

GREY TINTED GLASS
4/20 mm

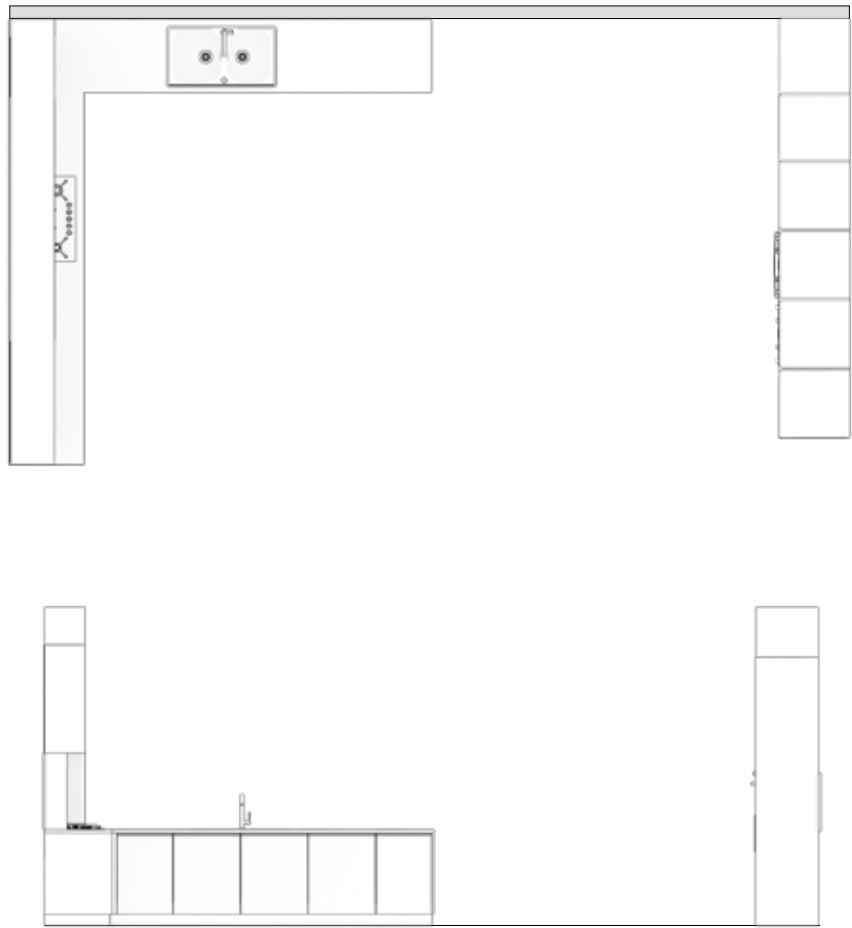

— **BASE, WALL & TALL UNITS**
carcass: mangolia
fronts: kendal oak and white
worktop: ivory mist
handle: FG010015298
glass: grey tinted

AVAILABLE IN

LAMINATES

GLASS



WHITE
(LIMITED) 18 mm

ONYX GREY
18 mm

ALANDPINE
18 mm

KENDAL OAK
18 mm

KANSAS OAK
18 mm

BROWN OAK
18 mm

TOBACCO OAK
18 mm

GREY TINTED GLASS
4/20 mm



MORENO

THE MARK OF A PRACTICAL KITCHEN





The Moreno kitchen combines practical design and economic solution. It delivers practicality and functionality to those seeking a kitchen that blends in with the style of a modern home.

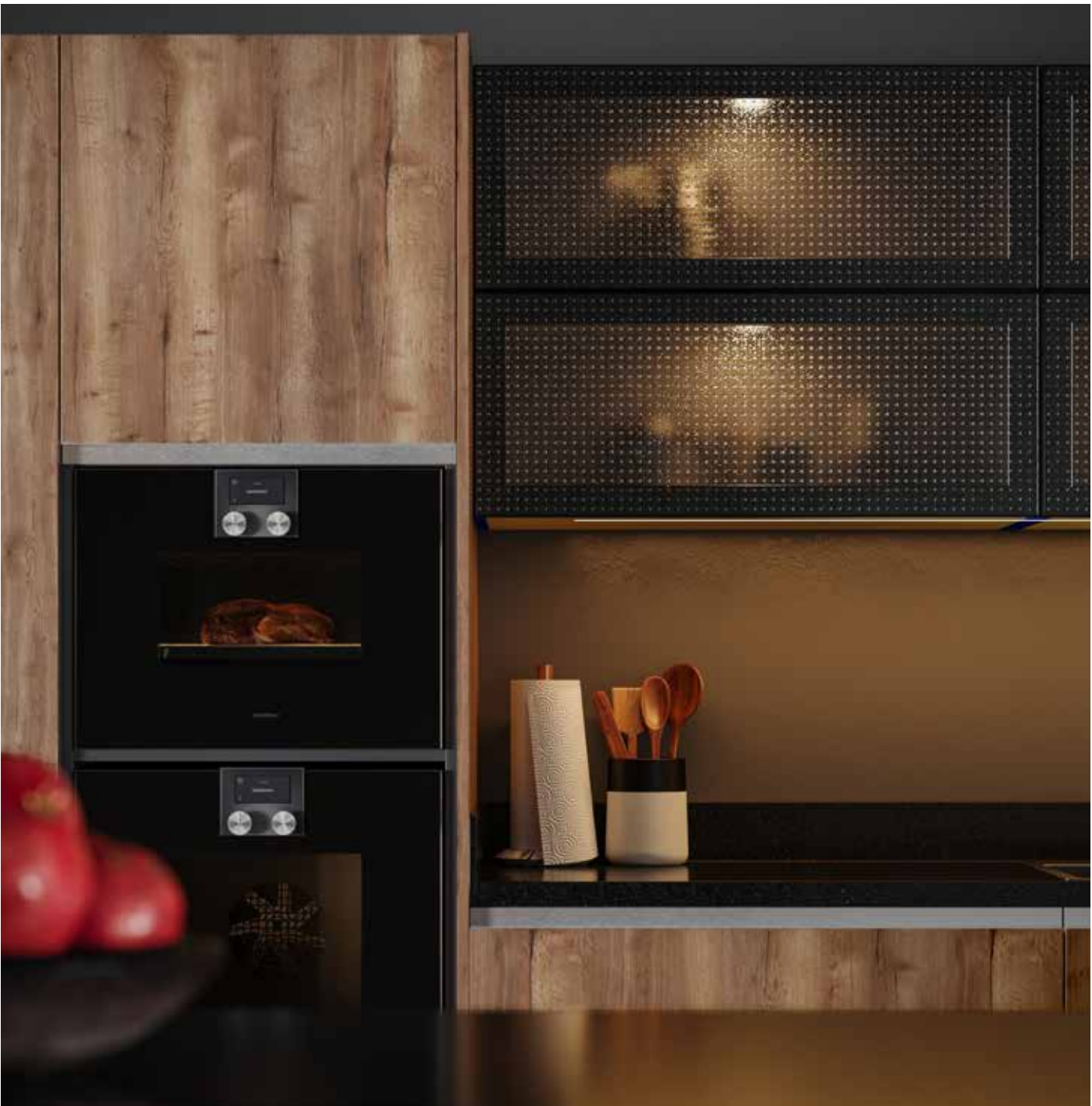

PALETTE



TOBACCO VALLEY OAK
18 mm



WHITE
18 mm



SOFT DOT GLASS
4/17 mm

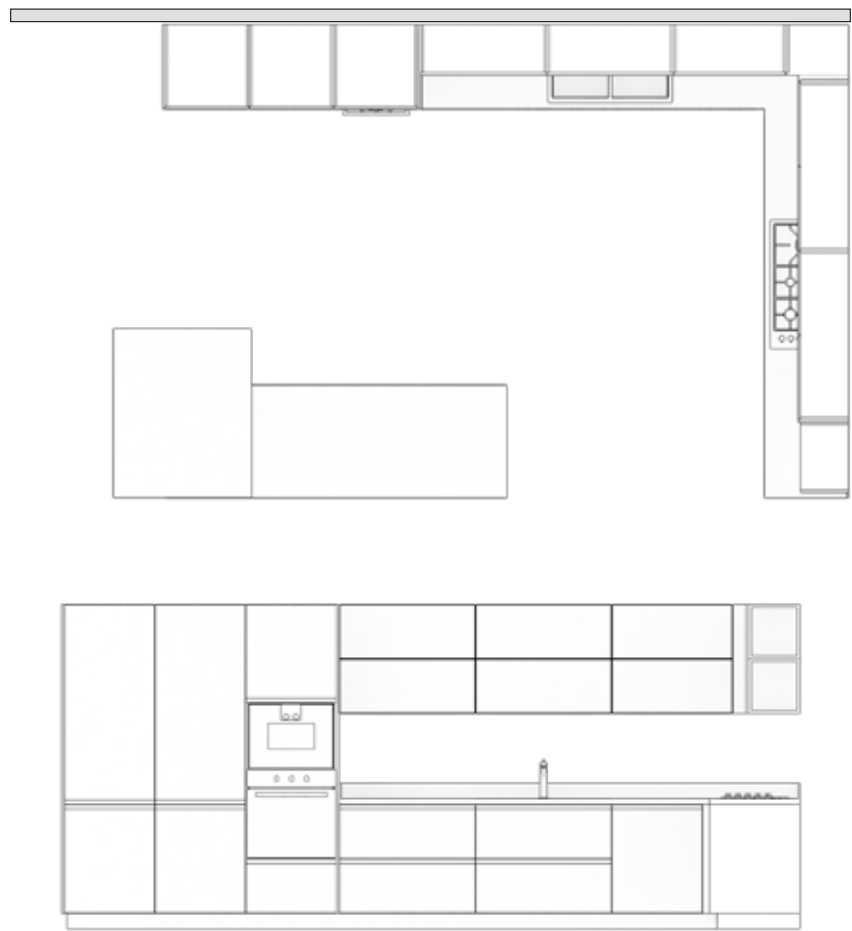

— **BASE, WALL & TALL UNITS**
carcass: white
fronts: tobacco valley oak
worktop: black quartz & dune prima
handle: FG010015298

AVAILABLE IN

LAMINATES

GLASS



CAPPADOCIA
17 mm



KERALA CONCRETE
17 mm



TOBACCO VALLEY OAK
17 mm



WALNUT TEX
17 mm



SOFT DOT GLASS
4/17 mm



DUNE

PRACTICAL AND DISTINCTIVE





A kitchen with crisp and clean lines that sets easily in any household. It tucks in all your necessities and makes it simple to keep your kitchen tidy and organized.



PALETTE



BRUSHED OAK
18 mm



WHITE
18 mm



SOFT DOT GLASS
4/17 mm

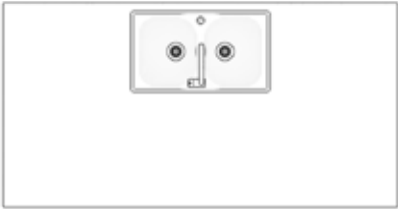

— **BASE, WALL & TALL UNITS**
carcass: white
fronts: brushed oak
worktop: black quartz
handle: FG040001016

AVAILABLE IN

LAMINATES



CANYON JURAPINE
17 mm



NATURAL VENEER
17 mm



TEAK
17 mm



NOCE PERENNE
17 mm



BORODINO ASH
17 mm



BRUSHED OAK
17 mm



SOFT DOT GLASS
4/17 mm

GLASS

KITCHEN ACCESSORIES

The Kitchen Storage Wonder!

What is the best way to organise my base units? How many cutlery trays do I need? Which waste separation system should I choose? What is more practical here: a larder unit or a pantry unit with internal pull-outs?

The following pages will give you some helpful suggestions on how to better organize your kitchen.



BASE PLATE RACK
FG0100-15271 | 15272
564W x 500D x 110H



WALL PLATE RACK
FG0100-15274 | 15275
843W x 245D x 520H



DETERGENT BASKET (Soft Closing)
FG010015260
235W x 445D x 440H

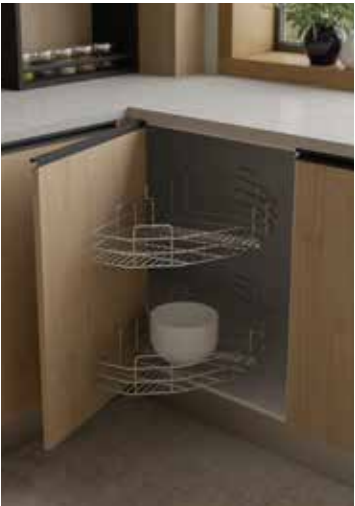

HALF MOON BASKET
FG010008379
760W x 390D x 100H



CUTLERY TRAY
FG01000-8397 | 8395 | 8398
500 | 600 | 900W x 490D x 45H



WASTE BIN
FG010008382
277W x 277D x 355H



PULL-OUT SHELVES
FG010015270 | FG010015269
860W x 450D x 470H



BASKET FOR SPICE JARS
FG010015267
110W x 500D x 520H



UNDER SINK TRAY
FG010015265
860W x 505D x 230H



DUST BIN
FG010015266
860W x 505D x 230H



JOLLY BASKET
FG010027731
110W x 470D x 485H



BASE PLATE RACK
FG010027733
564W x 425D x 140H



DISH RACK
FG010027732
865W x 280D x 65H



Tandem Box Drawer Height M

- FG010027319 | FG010027434 (Blumotion)
FG010027320 | FG010027435 (Tip-on Blumotion)
- Width 600 - 1200 mm
 - Depth 500 mm
 - Height 98.5 mm
 - Dynamic Carrying capacity 30 Kg
 - Includes integrated BLUMOTION for silent and effortless closing action, can be combined with SERVO-DRIVE
 - Either with TIP-ON BLUMOTION for handle-less furniture, or even for furniture with handle elements as a design feature



Tandem Box Inner Pull-out Box Cover

- FG010027324 | FG010027438 (Blumotion)
- Width 600 - 1200 mm
 - Depth 500 mm
 - Height 224 mm
 - Dynamic Carrying capacity 30 Kg
 - Easy access from three sides
 - Individually opening pull-outs allow for a complete overview and convenient removal from above
 - Light operating forces even with heavily-laden pull-outs
 - Flexible cabinet dimensions possible



Space Corner Tandem Height D

- FG010027330 (Blumotion)
- Depth 600 mm
 - Height 227 mm
 - Special drawer side which allows you to create personalised designs
 - Timelessly simple with BOXCAP or with a design element of your choice
 - Closed and seamless side panels
 - Consistent colour scheme



Aventos HK-XS Tip-on Lift System

- FG010027365
- Well-suited for low frontal heights in the wall cabinet, the high cabinet and over the refrigerator
 - Cabinet height KH 240-600 mm
 - Internal cabinet depth LT min. 125 mm (100 mm)
 - Closes silently and effortlessly in conjunction with CLIP top BLUMOTION hinges
 - TIP-ON for handle-less stay lifts
 - Light operating forces
 - Perfect motion with a variable stop
 - Simple, infinitely variable lift mechanism



Tandem Box Pull-out BOXCAP

- FG010027322 | FG010027437 (Blumotion)
FG010027323 | FG010027439 (Tip-on Blumotion)
- Width 600 - 1200 mm
 - Depth 500 mm
 - Height 224 mm
 - Dynamic Carrying capacity 30 Kg
 - Includes integrated BLUMOTION for silent and effortless closing action, can be combined with SERVO-DRIVE
 - Either with TIP-ON BLUMOTION for handle-less furniture, or even for furniture with handle elements as a design feature



Sink Cabinet Pull-out BOXCAP

- FG010027325 (Blumotion)
FG010027552 (Tip-on Blumotion)
- Width 800 - 1200 mm
 - Depth 500 mm
 - Height 98.5 mm
 - Dynamic Carrying capacity 30 Kg
 - Includes integrated BLUMOTION for silent and effortless closing action
 - Either with TIP-ON BLUMOTION for handle-less furniture, or even for furniture with handle elements as a design feature



Servo Drive for Tandem Box

- FG0100-27326 | 27327 | 27328
- With SERVO-DRIVE, opening handle-less pull-outs is child's play.
 - A light touch on the front with the foot, knee or hip is all that's required.



Tandem Box Inner Drawer Height M

- FG010027321 | FG010027436
- Width 600 - 1200 mm
 - Depth 500 mm
 - Height 98.5 mm
 - Dynamic Carrying capacity 30 Kg
 - Easy access from three sides
 - Individually opening pull-outs allow for a complete overview and convenient removal from above
 - Light operating forces even with heavily-laden pull-outs
 - Flexible cabinet dimensions possible



Space Corner Tandem Height M

- FG010027331 (Blumotion)
- Depth 600 mm
 - Height 101 mm
 - Special drawer side which allows you to create personalised designs
 - Timelessly simple with BOXCAP or with a design element of your choice
 - Closed and seamless side panels
 - Consistent colour scheme



Aventos HF Servo Drive

- FG010027329
- Ideal for wall cabinets with divided fronts
 - Cabinet height KH 480-1040 mm
 - Cabinet width KB up to 1800 mm
 - Silent and effortless closing, thanks to BLUMOTION
 - Light operating forces
 - Simple, infinitely variable lift mechanism
 - Centre hinge with finger safety feature

KITCHEN APPLIANCES

We want to be a part of your Kitchen!

HOODS

An exclusive range of Hoods for a smoke-free kitchen.



FG010009934
Built in Hood (80cm)

Material: SS430 + Silver
Suction: 300-800 m³/h
Switches: 4 speed Level
Features:
Aluminum grease filter
Lamps: 2x20 W Halogen Lights
Carbon Filter for Recirculation
Air Outlet: 150mm
Noise level: 43-64 dba
Origin: Made in Italy



FG010027868
Built in Hood (90cm)

Material: SS430 + Black Panel
Suction: 1300 m³/h
Switches: Touch Control - 3 Speed Level
Features:
Wing-like surround suction plate
100-sec turbo system
Illuminated side touch control
Rounded edge
Oil filter: Corrugated filter
Noise level ≤57dB
Origin: Made in China



FG010027297
Wall Mounted Hood (90cm)

Material: SS430 + Tempered glass
Suction: 1150 m³/h
Switches: Button control | 2 speed levels
Features:
Removable filter and easy to clean
Silent turbine
Lamps: 2x1.5 W LED, energy saving
Automatic turbo system
Noise level: < 62dba
Auto smoke sensor
Origin: Made in China



FG010027647
Wall Mounted Hood (90 cm)

Material: SS430
Suction: 1450 m³/h
Switches: Touch control - 2 Speed Level
Features:
Corrugated
Illuminated 'O' Touch Control
Lamps: 1 x 2 W LED Lights, Energy Saving
Anion Sterilization
Automatic Turbo System
Noise level: < 51 dba
Patented Wing-like Surround Suction Plate
Origin: Made in China



FG010027872
Wall Mounted Hood (90 cm)

Material: SS430
Suction: 750 m³/h
Features:
Canopy Design
Black Steel Body
Buffle filters
Touch Button operation
Double neck
Complete copper winding around the motor
Origin: Made in China



FG010027873
Wall Mounted Hood (90cm)

Material: Glass
Suction: 750 m³/h
Features:
Canopy Design
Black Steel Body
Buffle filters
Touch Button operation
Double neck
Complete copper winding around the motor
Origin: Made in China

HOBS

Our extremely sophisticated range of Hobs harmonized with an array of cutting-edge and “easy to use” functions will make your cooking experience an exciting one.



FG010027294

Material: Tempered glass
Size: 90cm
Energy type: NG/LPG
Flame pressure + Position:
Right: Double ring (4.85 KW)
Left: Double ring (4.85 KW)
Center: Semi rapid (1.75 KW)
Features:
Even flame technology | Heat efficiency > 60%
Safety ignition pin | Flame failure device (FFD)
Cast iron grate | Fast ignition | Low battery reminder
Removeable washing cup
Origin: Made in China



FG010027869

Material: Glass
Size: 78cm
Energy type: NG/LPG
Flame pressure + Position:
Right: Double ring (4.5 KW)
Left: Double ring (4.5 KW)
Center: Semi rapid (2.3 KW)
Features:
Cast iron pan supports | EPS Burners
Auto Ignition | Flame failure device (FFD)
Weight 65 kg | 780 L X 450 W X 0.75 H mm
Origin: Made in China



FG010027293

Material: SS304
Size: 90cm
Energy type: NG/LPG
Flame pressure + Position:
Right: Double ring (4.85 KW)
Left: Double ring (4.85 KW)
Center: Semi rapid (1.75 KW)
Features:
EPS technology | Heat efficiency > 60%
Safety ignition pin | Flame failure device (FFD)
Cast iron grate | Fast ignition | Low battery reminder
Removeable washing cup
Origin: Made in China



FG010027870

Material: Steel
Size: 78cm
Energy type: NG/LPG
Flame pressure + Position:
Right: Double ring (4.5 KW)
Left: Double ring (4.5 KW)
Center: Semi rapid (2.3 KW)
Features:
Cast iron pan supports | EPS Burners
Auto Ignition | Flame failure device (FFD)
Weight 65 kg | 780 L X 450 W X 0.75 H mm
Origin: Made in China



FG010027287

Material: SS304
Size: 90cm
Energy type: NG/LPG
Flame pressure + Position:
Front Left: Rapid (3.0 KW)
Rear Left: Semi-rapid (1.75 KW)
Front Right: Semi-rapid (1.0 KW)
Rear Right: Auxiliary (1.0 KW)
Central: Double ring (4 KW/5 KW)
Features:
Flame failure device (FFD) | Auto ignition integrated
Cast iron grids pan support | Removable washing cups
Origin: Made in Italy



FG010027871

Material: Glass
Size: 90cm
Energy type: NG/LPG
Flame pressure + Position:
Right: Double ring (4.5 KW)
Left: Double ring (4.5 KW)
Center: Semi rapid (1.75 KW)
Features:
Easy clean scratch resistant surface | Auto Ignition: Yes
Even heat distribution | FFD Safety: Yes
Italian Burners (SABAF) | Spacious Design for Big Pots
Origin: Made in China

OVENS & MICROWAVES

Designed to cater to individual needs of every kitchen, Interwood now brings to you an exciting selection of ovens that offer precision and performance like never before. With a variety of innovative features now you can cook up a delicious cuisine in no time.



FG010027305

Material: SS304
Size: 60cm
Cavity: 25 Litre
Energy Type: Electric
Handle: Aluminium
Power: 800 W output, 850 W grill, 1350 W microwave
Features:
Large LED display | Child safety lock
Constant temperature control technology
8 express cooking menus | Microwave & grill heating
Independent ventilation system
Pop-out rotatory control
Origin: Made in China



FG010027876

Material: Glass, Black Finish
Size: 60cm
Cavity: 56 Litre
Energy Type: Electric
Features:
04 functions Convection fan | Aluminium bar handle
Automatic cut off time
Cavity cooling system | Oven ventilation system
Double glazed glass door | Large viewing window
5 shelf positions | Power: 2700w
Origin: Made in China



FG010027649

Material: Tempered Glass
Size: 60cm
Cavity: 70 Litre
Energy Type: Electric
Features:
Classic Design | A Energy Class
3D Convection Fan
Origin: Made in China



FG010027306

Material: Black tempered glass
Size: 60cm
Cavity: 25 Litre
Energy Type: Electric
Handle: Aluminium
Power: 800 W output, 850 W grill, 1350 W microwave
Features:
Large LED display | Child safety lock
Constant temperature control technology
8 express cooking menus | Microwave & grill heating
Independent ventilation system | Touch control
Pop-out rotatory control
Origin: Made in China



FG010027874

Material: SS304 + Glass
Size: 60cm
Cavity: 25 Litre
Features:
Built-in-microwave oven | LED display
5 micro power levels | Child lock
8 built-in auto cook options
Mirror glass door | Stainless steel cavity
Origin: Made in China



FG010027875

Material: SS Finish
Size: 60cm
Cavity: 25 Litre
Features:
Built-in-microwave oven | LED display
5 micro power levels | Child lock
8 built-in auto cook options
Mirror glass door | Stainless steel cavity
Origin: Made in China



FG010027877

Material: Steel, Black Finish
Size: 60cm
Cavity: 56 Litre
Energy Type: Electric
Features:
04 functions Convection fan | Aluminium bar handle
Automatic cut off time
Cavity cooling system | Oven ventilation system
Double glazed glass door | Large viewing window
5 shelf positions | Power: 2700w
Origin: Made in China

SINKS & TAPS

Introducing a sophisticated and elegant range of Sinks and Taps, which have the technology of preventing water wastage, setting your Interwood kitchen apart from the rest.



FG010004370
SINGLE BOWL

Material: Stainless Steel 304
Size: 510 W x 510 D x 175 H
Installation: Over the counter
Including: Drainage kit
Finish: Bright
Origin: Made in Portugal



FG010004376
1-1/2 BOWL WITH TRAY

Material: Stainless Steel 304
Size: 1000 W x 500 D x 170 H
Installation: Over the counter
Including: Drainage kit
Finish: Bright
Origin: Made in Portugal



FG010004373
2 BOWLS WITH TRAY

Material: Stainless Steel 304
Size: 1160 W x 500 D x 160 / 200 H
Installation: Over the counter
Including: Drainage kit
Finish: Bright
Origin: Made in Portugal



FG010004371
SINGLE BOWL

Material: Stainless Steel 304
Size: 440 W x 440 D x 200 H
Installation: Over/Under the counter
Including: Drainage kit
Finish: Bright
Origin: Made in Portugal



FG010004375
SINK OKIO FLAT

Material: Stainless Steel 304
Size: 1160 W x 50 D x 160/200 H
Installation: Over the counter
Finish: Bright
Origin: Made in China



FG010004385
1-1/2 BOWL WITH TRAY

Material: Stainless Steel 304
Size: 510 W x 510 D x 175 H
Installation: Over the counter
Including: Drainage kit
Finish: Bright
Origin: Made in Portugal



FG010004372
SINGLE BOWL WITH TRAY

Material: Stainless Steel 304
Size: 860 W x 500 D x 200 H
Installation: Over the counter
Including: Drainage kit
Finish: Bright
Origin: Made in China



FG0100027307
ROUND EDGES

Material: Stainless Steel 304
Size: 580 W x 480 D
Installation: Over/Under the counter
Finish: Bright
Origin: Made in China



FG0100027308
SEMI ROUND BOWL

Material: Stainless Steel 304
Size: 430 W x 410 D
Installation: Over the counter
Finish: Bright
Origin: Made in China



FG010027310
1-1/2 BOWL WITHOUT TRAY

Material: Stainless Steel 304
Size: 870 W x 500 D
Installation: Over the counter
Finish: Bright
Origin: Made in China



FG010027313
1-1/4 BOWLS WITH TRAY

Material: Stainless Steel 304 (Tempered glass top)
Size: 980 W x 500 D
Installation: Over the counter
Finish: Bright
Origin: Made in China



FG010004368

Material: Brass
Size: 130/160 H mm
Installation: Over the counter
Finish: Chrome
Origin: Made in Portugal



FG010027779

Material: Brass
Size: 294/254 H mm
Installation: Over the counter with hose
Finish: Chrome
Origin: Made in Portugal



FG0100027311
DOUBLE BOWLS WITHOUT TRAY

Material: Stainless Steel 304
Size: 818 W x 498 D
Installation: Over the counter
Finish: Bright
Origin: Made in China



FG0100027312
1-3/4 BOWLS WITHOUT TRAY

Material: Stainless Steel 304
Size: 930 W x 500 D
Installation: Over the counter
Finish: Bright
Origin: Made in China



FG010004378

Material: Brass
Size: 330/245 H mm
Installation: Over the counter
Finish: Chrome
Origin: Made in Portugal



FG010004380

Material: Brass
Size: 310/280 H mm
Installation: Over the counter
Finish: Chrome
Origin: Made in Portugal



FG010004381

Material: Brass
Size: 355/245 H mm
Installation: Over the counter
Finish: Chrome
Origin: Made in Portugal



FG010027317

High-end kitchen faucet
Smooth & nice handling
Stainless Steel Faucet
1 Year leakage warranty
Origin: Made in China



FG010027316

High-end kitchen faucet
Smooth & nice handling
Stainless Steel Faucet
1 Year leakage warranty
Origin: Made in China



FG010027315

High-end kitchen faucet
Smooth & nice handling
Stainless Steel Faucet
1 Year leakage warranty
Origin: Made in China



FG010004369

Material: Brass
Size: 260/215 H mm
Installation: Over the counter
Finish: Chrome
Origin: Made in Portugal



FG010004382

Material: Brass
Size: 145/130 H mm
Installation: Over the counter with hose
Finish: Chrome
Origin: Made in Portugal

WORK TOPS

DEKTON



FG010027758
AURA



FG010027759
MARENGO



FG010027756
KELYA

MARBLE



FG010015343
DIAGNOSE WHITE



FG010015345
ROYAL BROWN-01



FG010015346
ROYAL BROWN-02



FG010015344
AUTUMN GREY

CORIAN / MONTELLI



FG010027683
WHITE ONYX



KC-22-BL-2106D
BLIZZARD



FG010027682
DUNE PRIMA



KC-22-A-67
IVORY MIST



KC-22-A-16-7829
AURORA-A



FG010027680
CARBON AGGREGATE



KC-22A-26-26-477
BLACK QUARTZ

POLYESTER



KC-22-B-32
SNOW WHITE



KC-22-A-PM222
AURORA-B



KC-22-A-PM223
STAR NIGHT

HANDLES

			
GS-01-1087 ANTIQUE BRASS	GS-01-1086 ANTIQUE BRASS	GS-01-1079 ANTIQUE BRASS	GS-23-1085 GOLDEN
			
GS-01-1077 VINTAGE BLACK	GS-23-1101 VINTAGE PEWTER	GS-23-10870BN OXIDIZED BRUSHED NICKLE	GS-23-10850BN OXIDIZED BRUSHED NICKLE
			
GS-23-1087 BLACK	GS-23-1086 BLACK	GS-23-10860BN OXIDIZED BRUSHED NICKLE	

LED LIGHTS

			
KCL-LEDAM6 OVER-CABINET LIGHT	KCL-LEDM6IR BAR LIGHT WITH SENSOR FOR CABINET/WARDROBE INTERIOR	KCL-LBL2M3045 UNDER-CABINET BAR LIGHT	KCL-LDL2M30501R DRAWER LIGHT WITH SENSOR
			
KCL-LED4SQ14K PLINTH LIGHT	KCL-KGL81006K CLIP ON SHELF LIGHT FOR GLASS ONLY	KCL-LEDA100TS LED STRIP LIGHT LENGTH 1025mm ONLY FOR 38mm TOP	FG0100-15255 15256 UNDER-CABINET LIGHT WITH SWITCH
			
FG0100-13289 13290 OPEN UNITS/INSIDE GLASS CABINETS/ COUNTER	FG0100-15253 15254 UNDER-CABINET LIGHT WITHOUT SWITCH	FG0100-15257 15258 INSIDE BASE CABINET/DRAWER	DRIVER KCL-AED151LSVKL3P FOR LIGHTS: LEDA100TS, GAL-21S & GDL-L21R
			
DRIVER KCL-AED151LSVKL6P FOR LIGHTS: LEDAM6, LEDM6-IR, LBL2M3-045, LDL2M3-050IR & LED-C045	DRIVER FG010013291 24V, 50W WITH CABLE AND EU PLUG	SAMPLE BOX FG010013292 24V, 6-WAYS+MML	

CABINETRY

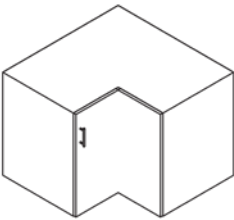

BI FOLD BASE CABINET
CODE 935-BC2_S-FO_7S
SIZE mm (W) 935

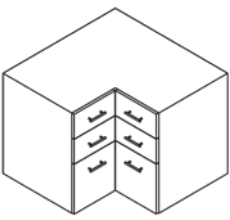

CORNER SPACE DRAWER BASE CABINET
CODE BS-BLUM-FO7S
SIZE mm (W) 935

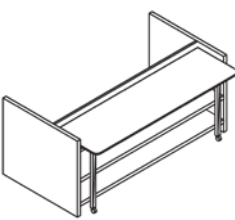

BREAKFAST COUNTER BASE CABINET
CODE BRK_FAST_CTR-FO_7S
SIZE mm (W) 1000, 1200, 1500

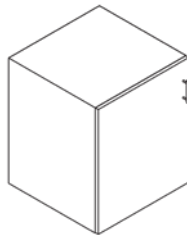

SINGLE SHUTTER BASE CABINET
CODE BS1_M-FO_7S
SIZE mm (W) 300, 400, 450, 500, 600

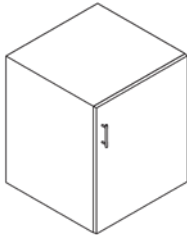

SINGLE SHUTTER SINK BASE CABINET
CODE 600-SU1_MP-FO_7S
SIZE mm (W) 600

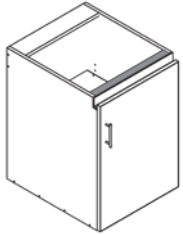

SINGLE SHUTTER BASE CABINET
CODE BS1_060B-EG_ST9
SIZE mm (W) 400, 450, 500, 600

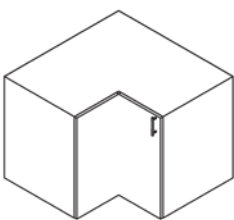

BI FOLD SINK BASE CABINET
CODE 935-SI_C2_S_MP-FO_7S
SIZE mm (W) 935

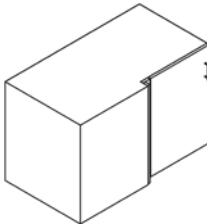

CORNER SINK BASE CABINET LEFT
CODE 1135-SC1_S-FO_7S
SIZE mm (W) 1135

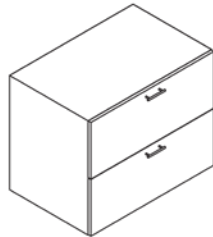

DOUBLE EQUAL DRAWER BASE CABINET
CODE BS_2EQ-FO_7S
SIZE mm (W) 300, 400, 450, 500, 600, 800, 900, 1000, 1200

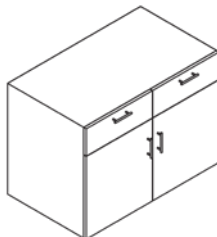

DOUBLE DRAWER & SHUTTER BASE CABINET
CODE BS2_A-FO_7S
SIZE mm (W) 800, 900, 1000, 1200

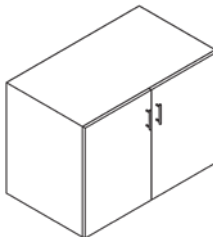

DOUBLE SHUTTER BASE CABINET
CODE BS2-FO_7S
SIZE mm (W) 800, 900, 1000, 1200

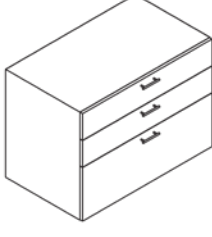

TRIPPLE DRAWER BASE CABINET FOR HOB
CODE BS_D3_2EQ_TB-FO_7S
SIZE mm (W) 450, 500, 600, 800, 900, 1000, 1200



FOUR DRAWER BASE CABINET
CODE BS_D4E-FO_7S
SIZE mm (W) 400, 500, 600, 800, 900, 1000

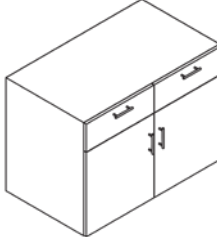

DOUBLE SHUTTER & DRAWER SINK BASE CABINET
CODE BS2_A-FO_7S
SIZE mm (W) 800, 900, 1000, 1200

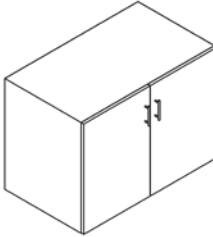

DOUBLE SHUTTER SINK BASE CABINET
CODE BS2-FO_7S
SIZE mm (W) 800, 900, 1000, 1200

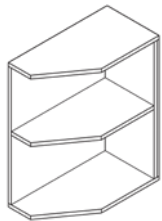

OPEN END BASE CABINET
CODE BOP_CB-FO_7S
SIZE mm (W) 300



OPEN BASE CABINET
CODE 300-BOP_CB-17-WA
SIZE mm (W) 300



OPERA OPEN END BASE CABINET
CODE 337-WOP_CB_N-203-WA
SIZE mm (W) 600

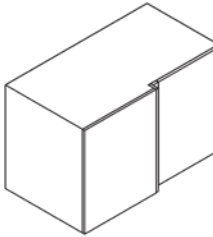

CORNER BASE CABINET LEFT
CODE 1135-BC1_SL_A053-FO_7S
SIZE mm (W) 1135

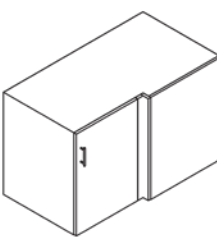

CORNER BASE CABINET RIGHT
CODE 1135-BC1_SR_A053-FO_7S
SIZE mm (W) 1135

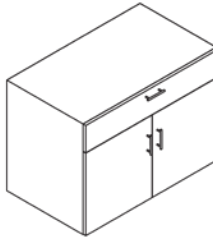

SINGLE DRAWER DOUBLE SHUTTER BASE CABINET
CODE BS2_1D-FO_7S
SIZE mm (W) 800, 900, 1000, 1200

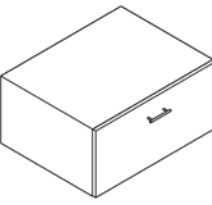

SINGLE DEEP DRAWER BASE CABINET
CODE BS_1TB-FO_7S
SIZE mm (W) 600, 800, 900, 1000, 1200

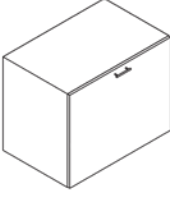

BASE CABINET DISHWASHER
CODE 600-BS1_WOP-FO_7S
SIZE mm (W) 600

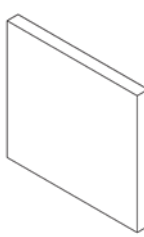

PILLAR BASE CABINET
CODE 75-BS_PILLAR-14
SIZE mm (W) 75

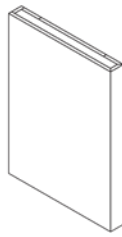

PILLAR BASE CABINET
CODE 75-BS_PILLAR-16
SIZE mm (W) 75

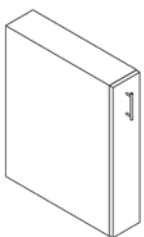

SINGLE SHUTTER PULL-OUT BASE CABINET
CODE 150-BS1_002-FO_7S
SIZE mm (W) 150

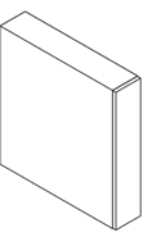

PILLAR BASE CABINET
CODE 150-BS_PILLAR-FO_7S
SIZE mm (W) 150

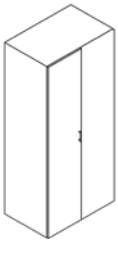

SINGLE SHUTTER TALL CABINET
CODE 1135-TC1_SL_A450_N
SIZE mm (W) 1135

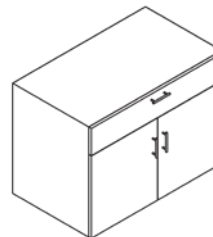

SINGLE DRAWER DOUBLE SHUTTER SINK
BASE CABINET
CODE SI2_1D-FO_7S
SIZE mm (W) 800, 900, 1000, 1200

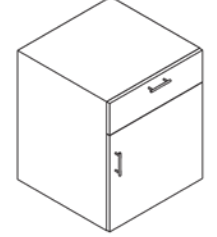

SINGLE DRAWER AND SHUTTER SINK
BASE CABINET
CODE BS1_A-FO_7S
SIZE mm (W) 500, 600

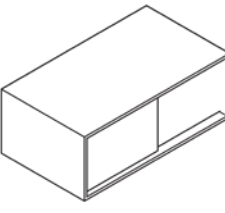

SLIDING BASE CABINET
CODE BS2_SLID-FO_7S
SIZE mm (W) 800, 1000, 1200

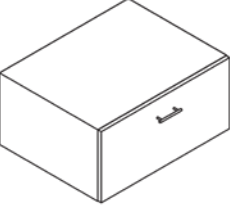

HANGING TANDEM BOX BASE CABINET
CODE BS_1TB_HANG-FO_7S
SIZE mm (W) 600, 750, 800, 900, 1000

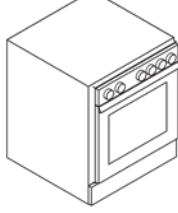

OVEN BASE CABINET
CODE OC_60-FO_7S
SIZE mm (W) 600

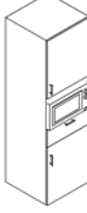

DOUBLE SHUTTER SINGLE DRAWER
MICROWAVE TALL CABINET
CODE 600-T03_1-FO_7S
SIZE mm (W) 600

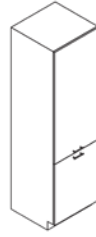

DOUBLE SHUTTER FRIDGE TALL CABINET
CODE 600-TO_FRIDGE_PB-FO_7S
SIZE mm (W) 600

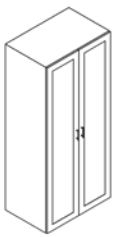

DOUBLE SHUTTER GLAZED TALL CABINET
CODE 1235-TC1_G2-FO_7S
SIZE mm (W) 1235

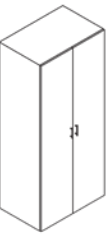

DOUBLE SHUTTER TALL CABINET
CODE 900-TG2_650A_N
Size mm (W) 900



DOUBLE SHUTTER SOLID TALL CABINET
CODE 600-TS2_N-203-WA
SIZE mm (W) 600

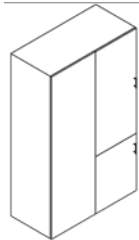

DOUBLE SHUTTER TALL CORNER CABINET
CODE 1135-TC1_SL_A450-FO_7S
SIZE mm (W) 1135



MEDIUM HEIGHT DOUBLE DRAWER
TALL CABINET
CODE 600-TO1_OVEN_2B-FO_7S
SIZE mm (W) 600

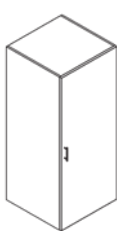

TALL CABINET MEDIUM HEIGHT SINGLE SHUTTER
WITH STORAGE
CODE 600-MT_S2_1440-FO_7S
SIZE mm (W) 600



SINGLE SHUTTER GLAZED TALL CABINET
CODE TG5_990-FO_7S
SIZE mm (W) 600



SINGLE SHUTTER SOLID TALL CABINET
CODE MTR_A230B_2000-FO_7S
SIZE mm (W) 600

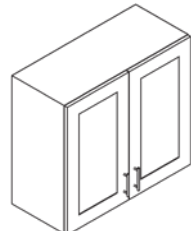

DOUBLE SHUTTER GLAZED
WALL CABINET
CODE WG2_1290-FO_7S
SIZE mm (W) 800, 900, 1000, 1200

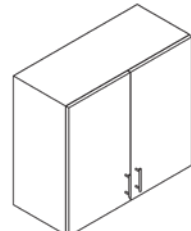

DOUBLE SHUTTER SOLID
WALL CABINET
CODE WS2_600-FO_7S
SIZE mm (W) 800, 900, 1000, 1200

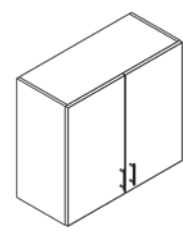

DOUBLE SHUTTER SOLID VOGUE
WALL CABINET
CODE WS2_720-FO_7S
WS2_960-FO_7S
SIZE mm (W) 800, 900, 1000, 1200

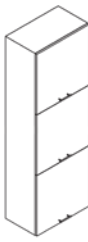

TRIPPLE SHUTTER WALL CABINET
CODE 600-WS1_1800_3-FO_7S
SIZE mm (W) 1800

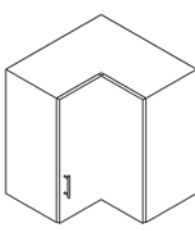

CORNER BI FOLD SOLID WALL CABINET
CODE 635-WC_S-FO_7S
SIZE mm (W) 635

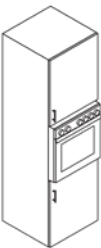

DOUBLE SHUTTER OVEN TALL CABINET
CODE 600-TO4_OVEN_60-FO_7S
SIZE mm (W) 600



DOUBLE SHUTTER SINGLE DRAWER
TALL CABINET
CODE 600-TO5-FO_7S
SIZE mm (W) 600



SINGLE SHUTTER & DRAWER
MICROWAVE & OVEN TALL CABINET
CODE 600-TO3_1_N
SIZE mm (W) 600

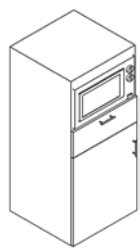

OPEN ONE PARTITION TALL CABINET
CODE 600-TO1_MC-FO_7S
SIZE mm (W) 600

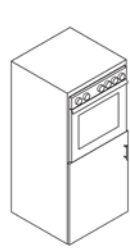

SINGLE SHUTTER OVEN TALL CABINET
CODE 600-TO1_OVEN-FO_7S
SIZE mm (W) 600

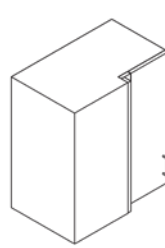

CORNER WALL CABINET LEFT
CODE 635-WC1_S-FO_7S
SIZE mm (W) 635



WALL END OPEN OPERA
CODE WOC_1200-203-WA
SIZE mm (W) 1200

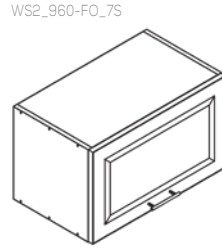

GLAZED FLAP WALL CABINET
CODE WF1_PL_S_360-FO_7S
WS2_960-FO_7S
SIZE mm (W) 600, 800, 900, 1000, 1200

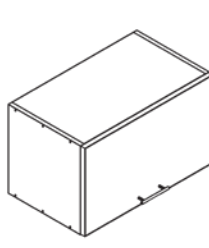

SOLID FLAP WALL CABINET
CODE WF1_SF_S_610-FO_7S
SIZE mm (W) 600, 800, 900, 1000, 1200

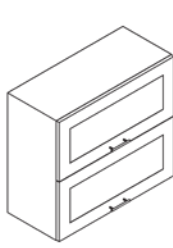

DOUBLE SHUTTER FLAP GALZED
WALL CABINET
CODE WF2_DF_G_720-FO_7S
SIZE mm (W) 600, 800, 900, 1000, 1200



OPEN STRIP TALL CABINET LEFT MINIMAL
CODE 300-TOC_2140-15-B0
SIZE mm (W) 300



OPEN STRIP TALL CABINET LEFT VOGUE
CODE 300-TOC_2140-15-WA
SIZE mm (W) 300



OPEN TALL CABINET PAINTED FRAME BROOKLYN
CODE 600-TOC_P_2205
SIZE mm (W) 300, 600



OPEN TALL CABINET PAINTED FRAME SOHO
CODE 600-TOC_P_2205
SIZE mm (W) 300, 600



SINGLE SHUTTER WITH PULL-OUT MECHANISM
TALL CABINET
CODE 450-TS1_250-FO_7S
SIZE mm (W) 450

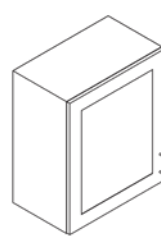

SINGLE SHUTTER GLAZED WALL CABINET
CODE WG1_600-FO_7S
SIZE mm (W) 400, 450, 500, 600

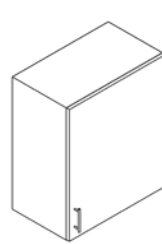

SINGLE SHUTTER SOLID WALL CABINET
CODE WS1_600-FO_7S
SIZE mm (W) 400, 450, 500, 600

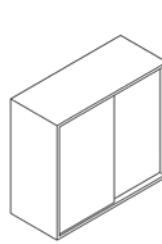

SLIDING GLAZED WALL CABINET
CODE WG2_SLID_600-FO_7S
SIZE mm (W) 800, 900, 1000, 1200

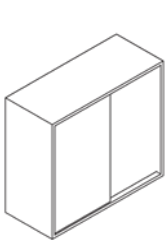

SLIDING SOLID WALL CABINET
CODE WS2_SLID_600-FO_7S
SIZE mm (W) 800, 900, 1000, 1200



OPEN WALL UNIT SPICE RACK
CODE WOC-SR-1290
Size mm (W) 600



PILLAR TALL CABINET
CODE 75-TL_PILLAR-14
SIZE mm (W) 75



PILLAR TALL CABINET
CODE 75-TL_PILLAR-16
SIZE mm (W) 75

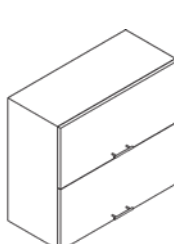

DOUBLE SHUTTER FLAP SOLID
HOOD WALL CABINET
CODE F2_S_H_720-FO_7S
SIZE mm (W) 600, 800, 900, 1000, 1200

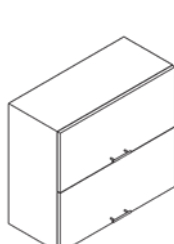

DOUBLE SHUTTER FLAP SOLID
WALL CABINET
CODE WF2_S_600-FO_7S
SIZE mm (W) 600, 800, 900, 1000, 1200

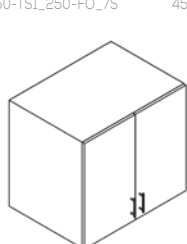

DOUBLE SHUTTER
WALL CABINET
CODE WS2_600-FO_7S
WS2_720-FO_7S
WS2_960-FO_7S
SIZE mm (W) 600, 900, 1000, 1200

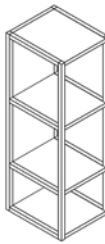

OPEN WALL CABINET BROOKLYN
CODE WOC_P
SIZE mm (W) 300, 600

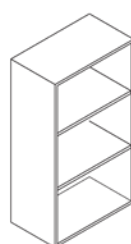

TWO SHELF OPEN WALL CABINET
CODE WOC_1080-FO_7S
SIZE mm (W) 300, 400, 450, 500, 600

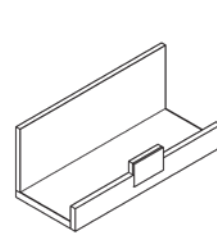

HANGING SHELF WALL CABINET OPERA
CODE WSH_HNG_V_N-203-WA
SIZE mm (W) 450, 500, 600, 800, 900, 1000, 1200

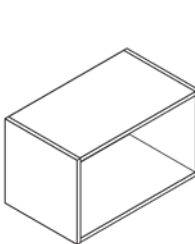

OPEN WALL CABINET
CODE WOC_360-FO_7S
SIZE mm (W) 300, 400, 450, 500, 600, 800, 900

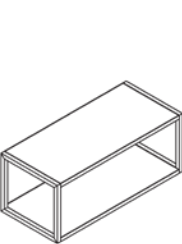

OPEN WALL CABINET
CODE 300-WOC_M
SIZE mm (W) 300, 400, 450, 500, 600, 800, 900

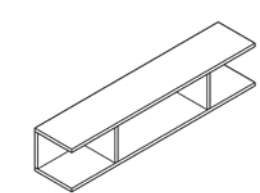

OPEN WALL CABINET WITHOUT FRAME VOGUE
CODE WOC_WF_240-15-BO
SIZE mm (W) 600, 900, 1200

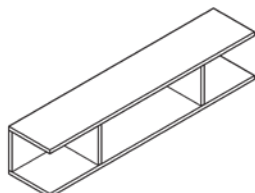

OPEN WALL CABINET WITHOUT FRAME
CODE WOC_WF_240-17-WA
SIZE mm (W) 600, 900, 1200

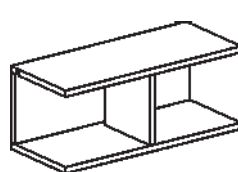

OPEN WALL UNIT WITHOUT FRAME
CODE 600-WOC_WF_240-17-WA
Size mm (W) 600

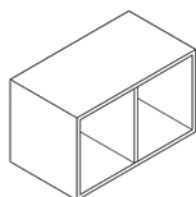

OPEN ONE PARTITION WALL CABINET
CODE WOC_360_1P-FO_7S
SIZE mm (W) 900, 1200

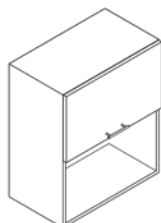

OPEN SOLID FLAP WALL CABINET
CODE WFL_PL_S_720-FO_7S
SIZE mm (W) 600, 800, 900, 1000, 1200



PILLAR WALL CABINET
CODE 15-TL_PILLAR-MI_277
SIZE mm (W) 150

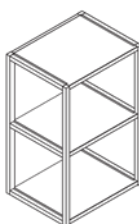

OPEN WALL CABINET PAINTED FRAME SOHO
CODE 300-WOC_P
SIZE mm (W) 300, 600



OPEN SHELF
CODE 337-WOP_CB-FO_7S
SIZE mm (W) 300, 400, 450, 500, 600



OPEN SHELF WITHOUT TOP
CODE WOC_720-FO_7S
SIZE mm (W) 300, 400, 450, 500, 600

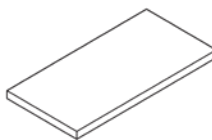

SOHO TOP
CODE 1800-ISL-900-14-OK
SIZE mm (W) 600, 800, 900, 1200

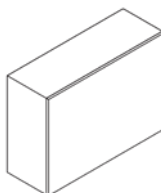

WALL CABINET HOOD
CODE 600-HOOD_360-FO_7S
SIZE mm (W) 600, 800, 900, 1000, 1200

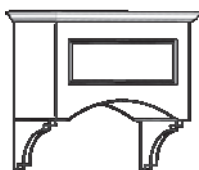

WALL CABINET HOOD (CLAIRE)
CODE HOOD-1040-12-JA
Size mm (W) 1140

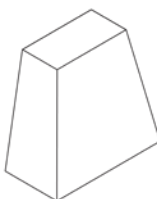

WALL CABINET HOOD SOHO
CODE 900-HOOD_800-14
SIZE mm (W) 900

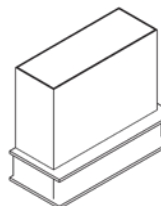

WALL CABINET HOOD BROOKLYN
CODE 1000-HOOD_840-16
SIZE mm (W) 600, 800, 900, 1000, 1200

TALL CABINET PERMUTATIONS

2040 / 2280 mm

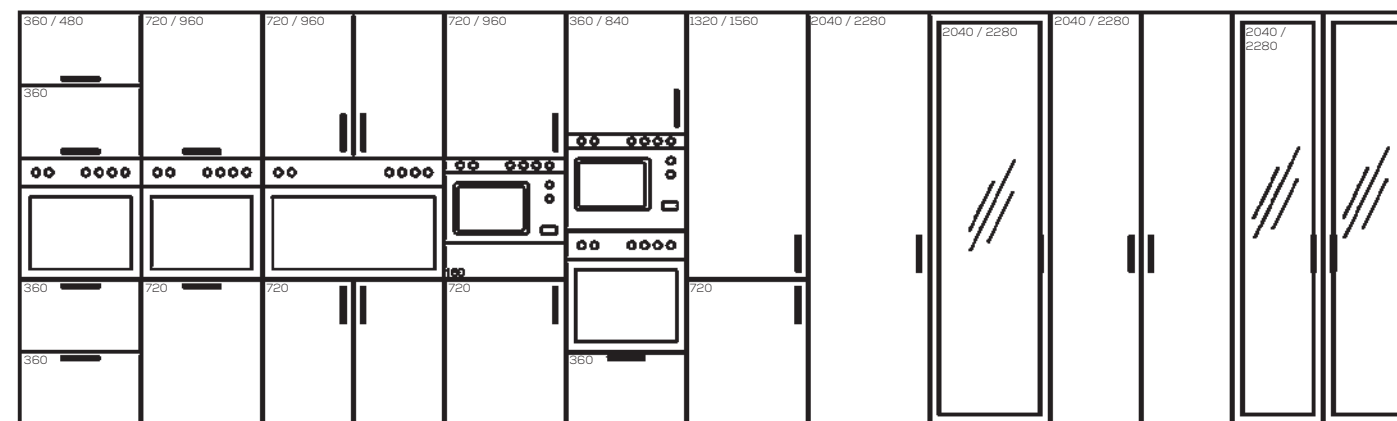

MEDIUM HEIGHT TALL CABINET PERMUTATIONS

1338 mm

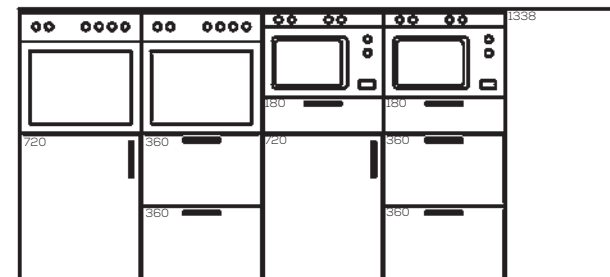

BASE CABINET PERMUTATIONS

720 mm

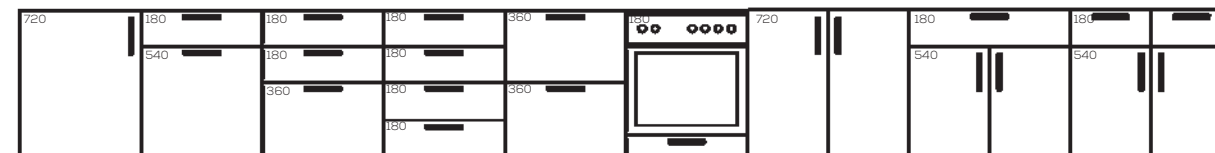

WALL CABINET PERMUTATIONS

600 / 720 / 960 mm

